

# Application for Conditional Use Retail Sale Alcoholic Beverages

Municipality of Anchorage  
Planning Department  
PO Box 196650  
Anchorage, AK 99519-6650

Please fill in the information asked for below.

PETITIONER*	PETITIONER REPRESENTATIVE (IF ANY)
Name (last name first)	Name (last name first)
Hox International Inc	STAFFORD, NOELLE
Mailing Address	Mailing Address
6905 ROCKLEDGE DRIVE BETHESDA, MD, 20817	PO Box 190231 ANCHORAGE, AK, 99519
Contact Phone: Day: 240-644-4865 Night:	Contact Phone: Day: 704-491-8505 Night:
FAX: 907 243 8636	FAX: 907-243-8636
E-mail:	E-mail:

\*Report additional petitioners or disclose other co-owners on supplemental form. Failure to divulge other beneficial interest owners may delay processing of this application.

PROPERTY INFORMATION
Property Tax #(000-000-00-000): 010-381-31
Site Street Address: 5000 W. INTERNATIONAL AIRPORT ROAD, ANCHORAGE, AK, 99502
Property Owner (if not the Petitioner): LEVEL 3 MEZZANINE
Current legal description: (use additional sheet in necessary)
LEASE LOT 23, ANCHORAGE INTL AIRPORT SW 1/4 WW 1/4 SECTION 33 TOWNSHIP 13 NORTH RANGE 4 WEST ANCHORAGE REGULATING DISTRICT - STATE OF ALASKA
Zoning: T Acreage: 2000 SF FLOOR Grid # SW 1924

ALCOHOLIC BEVERAGE CONTROL BOARD LICENSE PROPOSED
<input type="checkbox"/> Beverage Dispensary <input checked="" type="checkbox"/> Beverage Dispensary-Tourism <input type="checkbox"/> Brew Pub <input type="checkbox"/> Package Store <input type="checkbox"/> Private Club <input type="checkbox"/> Public Convenience <input type="checkbox"/> Recreational <input type="checkbox"/> Restaurant <input type="checkbox"/> Restaurant, exempt <input type="checkbox"/> Theater <input type="checkbox"/> Other (Please explain):
Is the proposed license: <input checked="" type="checkbox"/> New <input type="checkbox"/> Transfer of location: ABC license number: # 5469 Transfer license location: Transfer licensed premises doing business as:

I hereby certify that (I am)(I have been authorized to act for) owner of the property described above and that I petition for a retail sale of alcoholic beverages conditional use permit in conformance with Title 21 of the Anchorage Municipal, Code of Ordinances. I understand that payment of the application fee is nonrefundable and is to cover the costs associated with processing this application, and that it does not assure approval of

Accepted by: FM	Poster & Affidavit: 1 + affidavit	Fee: \$4,500	Case Number: 2016-0050
-----------------	-----------------------------------	--------------	------------------------

the conditional use. I also understand that assigned hearing dates are tentative and may have to be postponed by Planning Department, Municipal Clerk, or the Assembly for administrative reasons.

3-17-16

Noelle Spafford

DIRECTOR OF OPERATIONS

Date

Signature (Agents must provide written proof of authorization)

Application for conditional use retail sale alcoholic beverages continued

### COMPREHENSIVE PLAN INFORMATION

Anchorage 2020 Urban/Rural Services: ☒ Urban ☐ Rural

Anchorage 2020 West Anchorage Planning Area: ☐ Inside ☐ Outside

Anchorage 2020 Major Urban Elements: Site is within or abuts:

☐ Major Employment Center ☐ Redevelopment/Mixed Use Area ☐ Town Center

☐ Neighborhood Commercial Center ☒ Industrial Center

☐ Transit - Supportive Development Corridor

Eagle River-Chugiak-Peters Creek Land Use Classification:

☐ Commercial ☐ Industrial ☐ Parks/opens space ☐ Public Land Institutions

☐ Marginal land ☐ Alpine/Slope Affected ☐ Special Study

☐ Residential at \_\_\_\_\_ dwelling units per acre

Girdwood- Turnagain Arm

☐ Commercial ☐ Industrial ☐ Parks/opens space ☐ Public Land Institutions

☐ Marginal land ☐ Alpine/Slope Affected ☐ Special Study

☐ Residential at \_\_\_\_\_ dwelling units per acre

### ENVIRONMENTAL INFORMATION (All or portion site affected)

Wetland Classification: ☐ None ☐ "C" ☐ "B" ☐ "A"

Avalanche Zone: ☐ None ☐ Blue Zone ☐ Red Zone

Floodplain: ☐ None ☐ 100 year ☐ 500 year

Seismic Zone (Harding/Lawson): ☐ "1" ☐ "2" ☐ "3" ☐ "4" ☐ "5"

### RECENT REGULATORY INFORMATION (Events that have occurred in last 5 years for all or portion site)

☐ Rezoning - Case Number:

☐ Preliminary Plat ☐ Final Plat - Case Number(s):

☐ Conditional Use - Case Number(s):

☐ Zoning variance - Case Number(s):

☐ Land Use Enforcement Action for

☐ Building or Land Use Permit for

☐ Wetland permit: ☐ Army Corp of Engineers ☐ Municipality of Anchorage

### DOCUMENTATION

- Required:
- ☐ Original signed application, plus 12 sets of:
  - ☐ Building Permit application for new construction or change of use, if applicable
  - ☐ Approved parking and landscape plan from Land Use Review
  - ☐ Site plan to scale depicting: building footprints; parking areas; vehicle and pedestrian circulation; lighting; landscaping; signage; and licensed premises location.
  - ☐ Building plans to scale depicting: floor plans indicating the location of sales and service areas; building elevations (photographs are acceptable).
  - ☐ Photographs of premises from each street frontage that include and show relationship to adjacent structures and the premises visible street address number.
  - ☐ Completed application and narrative: explaining the project; construction, operation schedule, and open for business target date.
  - ☐ Zoning map showing the proposed location.
  - ☐ Completed Alcoholic Beverage Control Board liquor license application form including all drawings and attachments, if filed with ABC Board.
- Optional:
- ☐ Traffic impact analysis
  - ☐ Economic impact analysis
  - ☐ Noise impact analysis

**PROPERTY OWNER AUTHORIZATION\*** (if petitioner is not property owner)

(I)(WE) hereby grant permission to and acknowledge that person shown as the petitioner on this application is applying for a conditional use permit for the retail sales of alcoholic beverages on a property under (MY)(OUR) ownership and that as part of the conditional use permit process the Assembly may apply conditions which will be (MY)(OUR) responsibility to satisfy.

	SEE ATTACHED LETTER OF AUTHORIZATION
--	--------------------------------------

Date

Signature

\*Report additional petitioners or disclose other co-owners on supplemental form. Failure to divulge other beneficial interest owners may delay processing of this application.

**FACILITY OPERATIONAL INFORMATION**

What is the proposed or existing business name (Provide both if name is changing):

SLEEPING LION AIRPORT LOUNGE

What is the gross leaseable floor space in square feet?

2000 SF

What is the facility occupant capacity?

168

What is the number of fixed seats(booth and non movable seats)?

25

What is the number non-fixed seats(movable chairs, stools, etc.)?

46

What will be the normal business hours of operation?

10 AM - 12:00 AM

What will be the business hours that alcoholic beverages will be sold or dispensed?

10:00 AM - 12:00 AM

What do you estimate the ratio of food sales to alcohol beverage sales will be?

40 % Alcoholic beverage sales

60 % Food sales

Type of entertainment proposed: (Mark all that apply)

☒ Recorded music ☐ Live music ☐ Floor shows ☐ Patron dancing ☐ Sporting events ☐ Other ☐ None

Do you propose entertainment or environmental conditions in the facility that will meet the definition of "indecent material" or "adult entertainment" as set forth by AMC 8.50.020 Minors-Disseminating indecent material? ☐ Yes ☐ No

Do you propose conditions in the facility that fall under AMC 10.40.050 Adult oriented establishment? ☐ Yes ☐ No

**DISTANCE FROM CHURCHES, DAY CARE, AND SCHOOLS**

Locate and provide the names and address of all churches, day care, and public or private schools within 200 feet of the site property lines

Name

Address

NONE WITHIN 200 FEET.



**PACKAGE STORES**

Provide the projected percentage of alcoholic product inventory in the store where the retail unit price is:

% less than \$5.00

% \$5.00 to \$10.00

% \$10.00 to \$25.00

% greater than \$25.00

N/A

**CONDITIONAL USE STANDARDS**

The Assembly may only approve the conditional use if it finds that **all** of the following 4 standards are satisfied. Each standard must have a response in as much detail as it takes to explain how your project satisfies the standard. The burden of proof rests with you. Use additional paper if needed.

Explain how the proposed conditional use furthers the goals and policies of the comprehensive development plan and conforms to the comprehensive development plan in the manner required by AMC 21.05.

~~ALTHOUGH~~ ~~ALTHOUGH~~ THE COMPREHENSIVE DEVELOPMENT PLAN DOES NOT ADDRESS THE SALE OF ALCOHOLIC BEVERAGES, A BEVERAGE DISPENSARY TOURISM LICENSE IS AN APPROPRIATE ANCILLARY USE TO THE PERDOMINANT PURPOSE OF THIS PROPERTY - TOURISM AND PROVIDING SERVICE TO THE TRAVELING PUBLIC.

Explain how the proposed conditional use conforms to the standards for that use in this title and regulations promulgated under this title.

THE BEVERAGE DISPENSARY LICENSE HELD BY HOST INTERNATIONAL AT THE ANCHORAGE AIRPORT PRE-DATES THE CONDITIONAL USE PERMIT REGULATION. HOWEVER, THE RENEWAL OF THESE LICENSES HAVE BEEN APPROVED ON ALL OCCASIONS WITHOUT PROTEST OR RESTRICTIONS.

Explain how the proposed conditional use will be compatible with existing and planned land uses in the surrounding neighborhood and with the intent of its use district.

THIS IS A TENANT IMPROVEMENT IN THE EXPANSION OF THE AIRPORT SOUTH TERMINAL. THIS USE HAS BEEN AND WILL CONTINUE TO BE COMPATIBLE WITH EXISTING AND PLANNED LAND USES IN THE SURROUNDING NEIGHBORHOOD

Explain how the proposed conditional use will not have a permanent negative impact on the items listed below substantially greater than that anticipated from permitted development:

1. Pedestrian and vehicular traffic circulation and safety.

ESTABLISH MENS ARE IN THE AIRPORT BEHIND SECURITY. PATRONS ARE NOT PROCEEDING TO VEHICULAR TRAFFIC. HOST HAS STRICT POLICIES REGARDING SERVICE OF ALCOHOLIC BEVERAGE TO PREVENT OVER SERVICE HOSPITALITY LICENSE.

2. The demand for and availability of public services and facilities.

N/A

3. Noise, air, water or other forms of environmental pollution.

N/A

4. The maintenance of compatible and efficient development patterns and land use intensities.

PATRONS ARE USING AIRPORT FACILITY

#### STANDARDS CHAPTER 10.50 ALCOHOLIC BEVERAGES

In the exercise of its powers and under AS 04.11.480 and 15 AAC 104.145 to protest issue, renewal and transfer or alcoholic beverage licenses within the Municipality of Anchorage, the Assembly shall consider whether the proposed license meets **each and every factor and standard** set forth below.

**Concentration and land use.** Whether transfer of location or issue of the requested license will negatively impact the community through an increase in the concentration of uses involving the sale or service of alcoholic beverages within the area affected and will conform to the separate standards of AMC 21.50.020.

How many active liquor licenses are located on the same property as your proposed license? 5

Within 1,000 feet of your site are how many active liquor licenses? 5

How would you rate this area's license concentration on a scale of 1 to 5 with 5 = high 2

How many active liquor licenses are within the boundaries of the local community council? 5

In your opinion, is this quantity of licenses a negative impact on the local community?

No

**Training.** If application is made for issue, renewal or transfer of a beverage dispensary license, restaurant or eating place license, or package store license, whether the applicant can demonstrate prospective or continued compliance with a Liquor "Server Awareness Training Program approved by the State of Alaska Alcoholic Beverage Control Board, such as or similar to the program for techniques in alcohol management (T.A.M.). Until such plan is approved, training by a licensee's employees in the T.A.M. shall constitute compliance with this ordinance.

*How many employees in direct contact with alcohol will be trained in accordance with the Alcoholic Beverage Control Board's Liquor Server Awareness Training Program?*

35- 40 All Associates serving Alcoholic Beverages

**Operations procedures.** If application is made for issue, renewal, or transfer of a license, whether the applicant can demonstrate prospective or continued compliance with operations procedures for licensed premises set forth in Section 10.50.035 of this code.

- ☐ Yes ☒ No Happy hours?  
☐ Yes ☒ No Games or contests that include consumption of alcoholic beverages?  
☒ Yes ☐ No Patron access and assistance to public transportation?  
☒ Yes ☐ No Notice of penalties for driving while intoxicated posted or will be posted?  
☒ Yes ☐ No Non-alcoholic drinks available to patrons?  
☐ Yes ☒ No Solicitation or encouragement of alcoholic beverage consumption?

**Public safety.** When application is made for the renewal or transfer of location or transfer of ownership of a beverage dispensary license restaurant or eating place license, or package store license, the Assembly shall consider whether the operator can demonstrate the ability to maintain order and prevent unlawful conduct in a licensed premises. In determining the operator's demonstrated ability to maintain order and prevent unlawful conduct, the Assembly may consider police reports, testimony presented before the Assembly, written comments submitted prior to or during the public hearing, or other evidence deemed to be reliable and relevant to the purpose of this subsection. For purposes of this section and Section 10.50.035 "licensed premises" shall include any adjacent area under the control or management of the licensee.

*What are the proposed precautions to maintain order and prevent unlawful conduct at the licensed premises?*

*inside facility:* MANAGEMENT PRESENCE IN ESTABLISHMENT. INTERACTION WITH EMPLOYEE AND PATRONS. ALL POTENTIAL DISRUPTIVE PATRONS REPORTED TO MANAGEMENT AND REFUSED SERVICE. APPLICATION OF TAM TECHNIQUES. CALL AIRPORT POLICE FOR ASSISTANCE

*outside facility:* MAINTAIN ASSOCIATE AWARENESS OF ALL PATRONS ENTERING ESTABLISHMENT. MAINTAIN CONSTANT COMMUNICATIONS WITH OTHER ADULT BEVERAGE UNITS REGARDING PREVIOUSLY SERVED PATRONS.

**Payment of taxes and debts.** When application is made for renewal of a license the assembly shall consider, pursuant to AS 4.11.330, whether the applicant is delinquent in payment of taxes owed to the Municipality. When application is made for transfer of ownership of a license the Assembly shall consider, pursuant to AS 4.11.360, whether the municipality has received either payment or adequate security, for the payment of any debts or taxes, including any estimated taxes for the current year, arising from the conduct of the licensed business. Adequate security" for the payment of debts and taxes may be in the form of: 1) escrowed funds sufficient to Pay the debts and taxes claimed and any escrow fees; 2) actual payment of debts and taxes claimed; or, 3) a guarantee agreement in accordance AMC 10.50.030. Any guarantee agreement shall be in writing, signed by the transferor, transferee and Municipality

☒ Yes ☐ No *Are real estate and business property taxes current?*  
☐ Yes ☒ No *Are there any other debts owed to the Municipality of Anchorage?*

**Public health.** If application is made for the renewal or transfer of location or transfer of ownership of a license, the Assembly shall consider whether the operator has engaged in a pattern of practices injurious to public health or safety, such as providing alcohol to minors or intoxicated persons, committing serious violations of State law relevant to public health or safety, or other actions within the knowledge and control of the operator which place the public health or safety at risk. In determining if a pattern of practices injurious to public health or safety exists, the Assembly may consider criminal convictions, credible proof of illegal activity even if not prosecuted, police reports, testimony presented before the Assembly, written comments submitted prior to or during the public hearing, or other evidence deemed to be reliable and relevant to the purpose of this subsection.

☒ Yes ☐ No *As the applicant and operator can you comply? If no explain*





Alaska International Airport System  
Ted Stevens Anchorage International Airport  
Fairbanks International Airport  
Leasing and Property Management  
P.O. Box 196960  
Anchorage, AK 99519-6960  
Main: 907.266.2420  
Fax: 907.266.2458  
Website: [www.anchorageairport.com](http://www.anchorageairport.com)

March 11, 2016

To Whom It May Concern:

The Ted Steven International Airport is working with the HMS Host to develop a Sleeping Lady Airport and virtual experience theater in Concourse C mezzanine, including alcoholic beverage service.

The Airport supports this new venue and believes this food and beverage opportunity will greatly benefit the traveling public, enhance their experience in Alaska and provide an entertainment element to the Airport's Concession program.

We look forward to working with the HMS Host as they develop their new venue.

Sincerely,

Javier O. Robinson  
Concessions Manager

PLOT DEFINITION	0.00	8 - dark GRAY	0.13	7 - WHITE	0.30	2 - YELLOW
	0.05	9 - light GRAY	0.15	1 - RED	0.40	4 - CYAN
	0.09	6 - MAGENTA	0.20	3 - GREEN	0.50	5 - BLUE

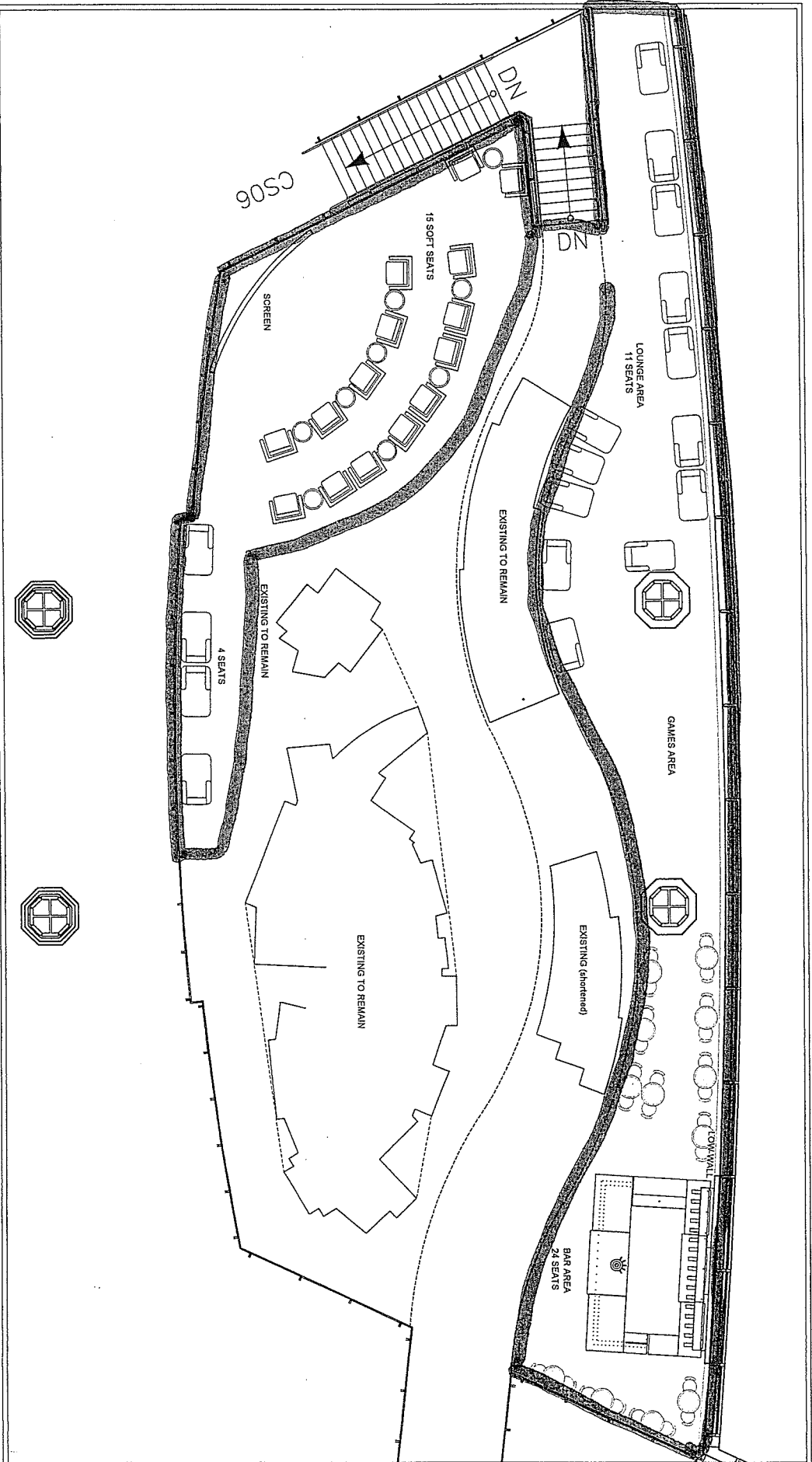

**HMS**  
H.O.S.T.  
FACILITY DESIGN  
& DEVELOPMENT

**ANCHORAGE  
INTERNATIONAL  
AIRPORT**

**BAR and LOUNGE  
-alternate-  
PROPOSED FLOOR PLAN**

REVISIONS	
No.	Date
05/28/15	Description

Scale: 1/8" = 1'-0"

17 x 11

DESIGN INTENT ONLY -  
NOT FOR CONSTRUCTION

• ALASKA'S •

# SLEEPING LADY

WINE BAR & LOUNGE



**SLEEPING LADY LOUNGE**  
**TED STEVENS ANCHORAGE INTERNATIONAL AIRPORT**  
**PRESENTATION MATERIALS**  
SEPTEMBER 17TH, 2015

**HMS**  
**HOST**



**ideation**  
DESIGN GROUP

# KEY

- 1 OPEN TO BELOW
- 2 BAR AREA
- 3 DINING AREA
- 4 EXISTING FLOORING TO REMAIN
- 5 EXISTING PLANTER
- 6 EXISTING ART DISPLAY
- 7 LOUNGE SEATING WITH POWER ,
- 8 USB PORTS & HEADPHONE JACKS
- 9 VIDEO GAME AREA
- 10 RELOCATED KIOSK
- 11 ELEVATOR
- 12 18" SIDE TABLES
- 13 42" HIGH SEATING
- 14 MOVIE SCREEN

..... CUSTOMER JOURNEY  
 ADA SEATING

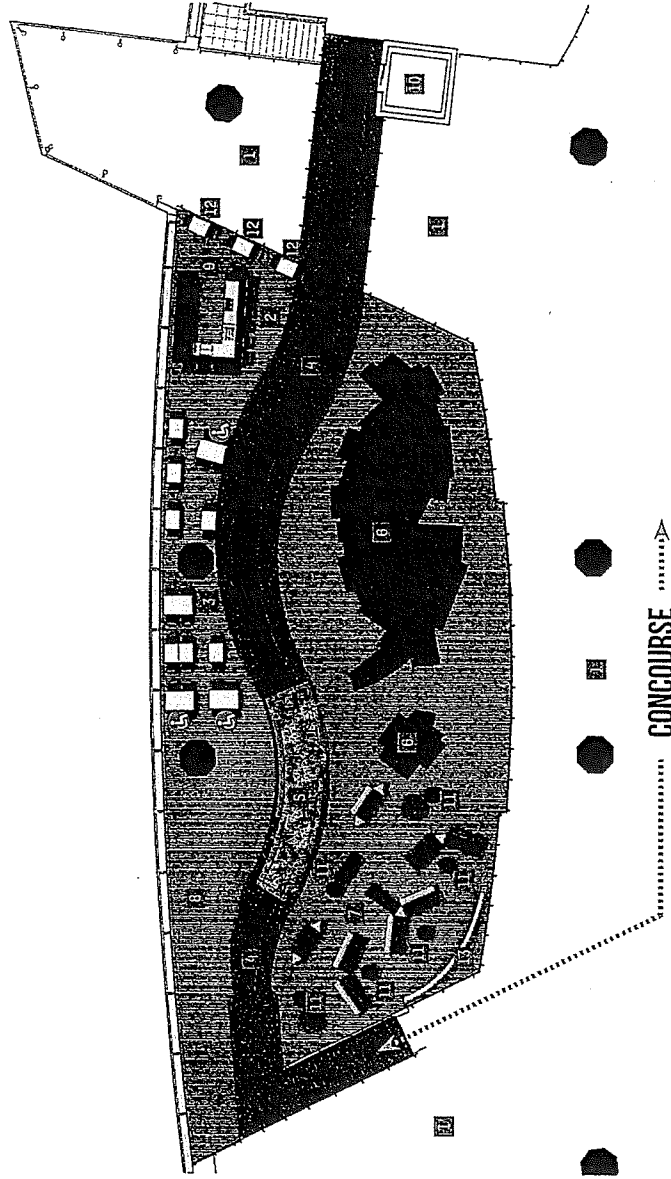

## SEAT COUNT

BAR SEATING	17
DINING SEATING	30
LOUNGE SEATING	34
TOTAL	81



**SLEEPING LADY LOUNGE - COLORED FLOOR PLAN**  
 TED STEVENS ANCHORAGE INTERNATIONAL AIRPORT  
 SEPTEMBER 17TH, 2015

ALASKA'S  
**SLEEPING LADY**  
 WINE BAR & LOUNGE

**HMS**  
 HOST





**SLEEPING LADY LOUNGE - RENDERING**  
 TED STEVENS ANCHORAGE INTERNATIONAL AIRPORT  
 SEPTEMBER 17TH, 2015



Alaska International Airport System  
Ted Stevens Anchorage International Airport  
Fairbanks International Airport  
Leasing and Property Management  
P.O. Box 196960  
Anchorage, AK 99519-6960  
Main: 907.266.2420  
Fax: 907.266.2458  
Website: [www.anchorageairport.com](http://www.anchorageairport.com)

March 11, 2016

To Whom It May Concern:

The Ted Steven International Airport is working with the HMS Host to develop a Sleeping Lady Airport and virtual experience theater in Concourse C mezzanine, including alcoholic beverage service.

The Airport supports this new venue and believes this food and beverage opportunity will greatly benefit the traveling public, enhance their experience in Alaska and provide an entertainment element to the Airport's Concession program.

We look forward to working with the HMS Host as they develop their new venue.

Sincerely,

Javier O. Robinson  
Concessions Manager

Alcoholic Beverage Control Board  
550 West 7<sup>th</sup> Ave. Suite 1600  
Anchorage, AK 99501

## New Liquor License

(907) 269-0350  
Fax: (907) 334-2285  
<http://commerce.alaska.gov/dnn/abc/Home.aspx>

License is: ☒ Full Year OR ☐ Seasonal List Dates of Operation: \_\_\_\_\_

SECTION A - LICENSE INFORMATION			FEES
Office Use: License Year: <u>2016</u>	License Type: <u>Beverage Dispensary - Tourism</u>	Statute Reference Sec. 04.11. <u>400(d)</u>	License Fee: \$ <u>2,500.00</u>
Office Use: License #: <u>5469</u>			Filing Fee: \$100.00 Rest. Desig. Permit Fee: \$ <u>50.00</u>
Local Governing Body: (City, Borough or Unorganized) <u>Municipality of Anchorage</u>	Community Council Name(s) & Mailing Address: <u>Sand Lake Turnagain</u> <u>1057 W. Fireweed La. 1057 W. Fireweed La.</u> <u>Anchorage, AK Anchorage, AK</u>		Fingerprint: \$ ( <u>\$49.75 per person</u> )
Name of Applicant (Corp/LLC/LP/LLP/Individual/Partnership): <u>Host International, Inc.</u>	Doing Business As (Business Name): <u>Sleeping Lady Airport Lounge</u>	Business Telephone Number: <u>907-243-4331 x21</u>	TOTAL <u>\$2,650.00</u>
Mailing Address: <u>6905 Rockledge Drive, MS 7-1</u>	Street Address or Location of Premises: <u>Ted Stevens Anchorage International Airport</u> <u>5000 West International Airport Road</u> <u>Anchorage, AK 99502</u>	Fax Number: <u>907-243-8636</u>	Email Address: <u>licensing@hmshost.com</u>
City, State, Zip: <u>Bethesda, MD 20817</u>			
SECTION B - PREMISES TO BE LICENSED			
Distance to closest school grounds: <u>2.2 miles</u>	Distance measured under: <input checked="" type="checkbox"/> AS 04.11.410 OR <input type="checkbox"/> Local ordinance No. _____	<input type="checkbox"/> Premises is GREATER than 50 miles from the boundaries of an incorporated city, borough, or unified municipality. <input type="checkbox"/> Premises is LESS than 50 miles from the boundaries of an incorporated city, borough, or unified municipality.	
Distance to closest church: <u>2.2 miles</u>	Distance measured under: <input checked="" type="checkbox"/> AS 04.11.410 OR <input type="checkbox"/> Local ordinance No. _____	<input checked="" type="checkbox"/> Not applicable	
Premises to be licensed is: <input type="checkbox"/> Proposed building <input checked="" type="checkbox"/> Existing facility <u>New construction in existing Airport Terminal</u> <input type="checkbox"/> New building		<input type="checkbox"/> Plans submitted to Fire Marshall (required for new & proposed buildings) <input checked="" type="checkbox"/> Diagram of premises attached	



## New Liquor License

### SECTION C – LICENSEE INFORMATION

1. Does any individual, corporate officer, director, limited liability organization member, manager or partner named in this application have any direct or indirect interest in any other alcoholic beverage business licensed in Alaska or any other state? [Please see attached Statement.](#)

☒ Yes ☐ No If Yes, complete the following. Attach additional sheets if necessary.

Name	Name of Business	Type of License	Business Street Address	State
Host International, Inc.	Upper One	Beverage Dispensary	5000 W. International Airport Rd.	Alaska
Host International, Inc.	Chili's Too	Beverage Dispensary-Tourism	5000 W. International Airport Rd.	Alaska
Host International, Inc.	Humpy's Great Alaskan Alehouse	Beverage Dispensary-Tourism	5000 W. International Airport Rd.	Alaska
Host International, Inc.	Norton Sound Seafood House	Beverage Dispensary-Tourism	5000 W. International Airport Rd.	Alaska
Host International, Inc.	Norton Sound Seafood House	Beverage Dispensary-Tourism Duplicate	5000 W. International Airport Rd.	Alaska

2. Has any individual, corporate officer, director, limited liability organization member, manager or partner named in this application been convicted of a felony, a violation of AS 04, or been convicted as a licensee or manager of licensed premises in another state of the liquor laws of that state?

☐ Yes ☒ No If Yes, attach written explanation.

### SECTION D – OWNERSHIP INFORMATION - CORPORATION

*Corporations, LLCs, LLPs and LPs must be registered with the Dept. of Community and Economic Development.*

Name of Entity (Corporation/LLC/LLP/LP) (or N/A if an Individual ownership): <a href="#">Host International, Inc.</a>		Telephone Number: <a href="#">240-694-4865</a>	Fax Number: <a href="#">240-694-4635</a>
Corporate Mailing Address: <a href="#">6905 Rockledge Drive, MS 7-1</a>	City: <a href="#">Bethesda</a>	State: <a href="#">Maryland</a>	Zip Code: <a href="#">20817</a>
Name, Mailing Address and Telephone Number of Registered Agent: <a href="#">Corporation Service Company, 9360 Glacier Highway, Suite 202, Juneau, AK</a>		Date of Incorporation OR Certification with DCED: <a href="#">12/11/1981</a>	State of Incorporation: <a href="#">Delaware</a>
Is the Entity in "Good Standing" with the Alaska Division of Corporations? <input checked="" type="checkbox"/> Yes <input type="checkbox"/> No If no, attach written explanation. Your entity <b>must</b> be in compliance with Title 10 of the Alaska Statutes to be a valid liquor licensee.			

#### Entity Members (Must include President, Secretary, Treasurer, Vice-President, Manager and Shareholder/Member with at least 10%)

Name	Title	%	Home Address & Telephone Number	Work Telephone Number	Date of Birth
<a href="#">Paul Mamalian</a>	<a href="#">President</a>	<a href="#">1%</a>	<a href="#">10631 Barn Wood Lane, Potomac, MD 20854</a>	<a href="#">240-694-4100</a>	<a href="#">06/30/1969</a>
<a href="#">Bernard N. Brown</a>	<a href="#">Vice Pres.</a>	<a href="#">0%</a>	<a href="#">3926 Lumo Circle, Randallstown, MD 21133</a>	<a href="#">240-694-4100</a>	<a href="#">04/11/1957</a>
<a href="#">Mark T. Ratych</a>	<a href="#">Treasurer</a>	<a href="#">1%</a>	<a href="#">813 Oak Knoll Terrace, Rockville, MD 20850</a>	<a href="#">240-694-4100</a>	<a href="#">01/19/1962</a>
<a href="#">Jeffrey L. Poersch</a>	<a href="#">Secretary</a>	<a href="#">1%</a>	<a href="#">47587 Woodboro Ter., Potomac Falls, VA 20165</a>	<a href="#">240-694-4100</a>	<a href="#">05/24/1983</a>
<a href="#">HMSHost Corporation</a>	<a href="#">Shareholder</a>	<a href="#">97%</a>	<a href="#">6905 Rockledge Drive, Bethesda, MD 20817</a>	<a href="#">240-694-4100</a>	<a href="#">N/A</a>

NOTE: If you need additional space, please attach a separate sheet.



## New Liquor License

### SECTION E – OWNERSHIP INFORMATION – SOLE PROPRIETORSHIP (INDIVIDUAL OWNER & SPOUSE)

**Individual Licensees/Affiliates** (The ABC Board defines an “Affiliate” as the spouse or significant other of a licensee. Each Affiliate must be listed.)

Name: Address:	Applicant <input type="checkbox"/> Affiliate <input type="checkbox"/>	Name: Address:	Applicant <input type="checkbox"/> Affiliate <input type="checkbox"/>
Home Phone: Work Phone:	Date of Birth:	Home Phone: Work Phone:	Date of Birth:
Name: Address:	Applicant <input type="checkbox"/> Affiliate <input type="checkbox"/>	Name: Address:	Applicant <input type="checkbox"/> Affiliate <input type="checkbox"/>
Home Phone: Work Phone:	Date of Birth:	Home Phone: Work Phone:	Date of Birth:

#### Declaration

- I declare under penalty of perjury that I have examined this application, including the accompanying schedules and statements, and to the best of my knowledge and belief it is true, correct and complete, and this application is not in violation of any security interest or other contracted obligations.
- I hereby certify that there have been no changes in officers or stockholders that have not been reported to the Alcoholic Beverage Control Board. The undersigned certifies on behalf of the organized entity, it is understood that a misrepresentation of fact is cause for rejection of this application or revocation of any license issued.
- I further certify that I have read and am familiar with Title 4 of the Alaska statutes and its regulations, and that in accordance with AS 04.11.450, no person other than the licensee(s) has any direct or indirect financial interest in the licensed business.
- I agree to provide all information required by the Alcoholic Beverage Control Board in support of this application.

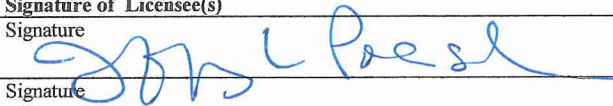
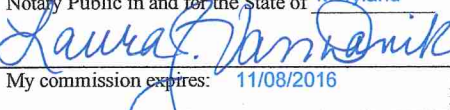
<b>Signature of Licensee(s)</b>	<b>Signature of Licensee(s)</b>
Signature 	Signature
Signature	Signature
Name & Title (Please Print) Jeffrey L. Poersch, Secretary	Name & Title (Please Print)
Subscribed and sworn to before me this 10th day of February, 2016	Subscribed and sworn to before me this day of
Notary Public in and for the State of Maryland 	Notary Public in and for the State of
My commission expires: 11/08/2016	My commission expires:

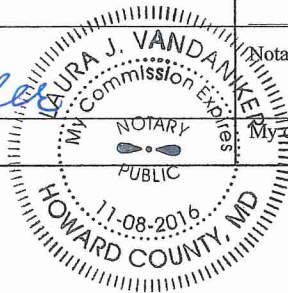

**Host International, Inc. d/b/a Sleeping Lady Airport Lounge  
New Liquor License**

**Section C – Licensee Information**

**Statement in Response to Question 1:**

Host International, Inc. ("Host") is a large food and beverage concessionaire which operates restaurants at airports, toll roads and malls throughout the United States and Canada. Host holds numerous licenses to sell alcoholic beverages at its various eating establishments.

STATE OF ALASKA  
ALCOHOLIC BEVERAGE CONTROL BOARD  
APPLICATION FOR RESTAURANT DESIGNATION PERMIT  
AS 04.16.049 & 3 AAC 304.715 – 794

The granting of this permit allows access of persons under 21 years of age to designated licensed premises for purposes of dining, and persons between the ages of 16 – 20 for employment. If for employment, please indicate in detail what the employment duties will be in question #3.

License Number: \_\_\_\_\_ Type: Beverage Dispensary - Tourism

This application is for designation of premises where: (Please check the appropriate items below)

- |             |  |
|-------------|--|
| 1. <u>X</u> | Bona fide restaurant pursuant to 3 AAC 304.305 & 3 AAC 304.715-794.            |
| 2. <u>X</u> | Persons 16 – 20 years of age may dine unaccompanied.                           |
| 3. <u>X</u> | Persons under 16 may dine accompanied by a person 21 years of age or older.    |
| 4. _____    | Persons between 16 – 20 years of age may be employed. <i>*(See note below)</i> |

Licensee's Name: Host International, Inc.

Name of Business: Sleeping Lady Airport Lounge

Business Address: 5000 W. International Airport Road City: Anchorage

1. Hours of operation 10:00 am to 12:00 am Telephone Number: 907-243-4331 Ext. 21

2. Have police been called to your premises for any reason? [ ] Yes [X] No  
(If you answered yes, please explain below).

3. \* Duties of employment: N/A

4. Are video games available to the public on your premises? [X] Yes [ ] No

5. Do you provide live entertainment, such as live music, pool tables, karaoke, dancing, sports or pin-ball?  
[ ] Yes [X] No

6. How is food served? [ ] Table Service [ ] Buffett Service [ ] Counter Service [X] Other Delivered to server from Pork & Pickle

7. Is an owner, manager or supervisor 21 years of age or older always present during business hours? [X] Yes [ ] No

\*\*\* A MENU AND DETAILED PREMISES DIAGRAM MUST ACCOMPANY THIS APPLICATION \*\*\*

\*Employees 16 and 17 years of age must have a valid work permit and a letter maintained in your files from a parent or guardian authorizing employment at your establishment.

\*\*Please attach additional sheets of paper if more space is needed to describe food service, entertainment, etc.

Licensee Signature

Local Governing Body Approval

Subscribed and sworn to before me this 15<sup>th</sup> day of March 2016

Date

Notary Public in and for Alaska

My Commission Expires

Director, ABC Board

Date

Rev. 03/17/2014

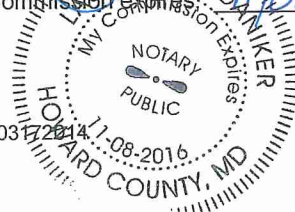

313718  
0001379741  
\$585.00

# AFFIDAVIT OF PUBLICATION

STATE OF ALASKA  
THIRD JUDICIAL DISTRICT

Emma Dunlap  
being first duly sworn on oath deposes and  
says that he/she is a representative of the  
Alaska Dispatch News, a daily newspaper.  
That said newspaper has been approved  
by the Third Judicial Court, Anchorage,  
Alaska, and it now and has been published  
in the English language continually as a  
daily newspaper in Anchorage, Alaska, and  
it is now and during all said time was  
printed in an office maintained at the  
aforesaid place of publication of said  
newspaper. That the annexed is a copy of  
an advertisement as it was published in  
regular issues (and not in supplemental  
form) of said newspaper on

February 05, 2016

and that such newspaper was regularly  
distributed to its subscribers during all of  
said period. That the full amount of the fee  
charged for the foregoing publication is not  
in excess of the rate charged private  
individuals.

Signed

*Emma Dunlap*

Subscribed and sworn to before me  
this 5th day of February, 2016

*Britney Thompson*

Notary Public in and for  
The State of Alaska.  
Third Division  
Anchorage, Alaska  
MY COMMISSION EXPIRES

*2/23/2019*

## APPLICATION FOR NEW LIQUOR LICENSE

Host International, Inc. is  
making application for a new  
Beverage Dispensary - Tourism  
liquor license AS 04.11.400(d),  
doing business as Sleeping  
Lady Lounge located at Ted  
Stevens Anchorage Interna-  
tional Airport, 5000 West Inter-  
national Airport Road, Anchor-  
age, AK 99502.

Interested persons should submit  
written comment to their local  
governing body, the applicant and  
to the Alcoholic Beverage Control  
Board at 550 West 7th Ave., Suite  
1600, Anchorage, AK 99501.

Notary Public  
BRITNEY L. THOMPSON  
State of Alaska

My Commission Expires Feb 23, 2019



**STATE OF ALASKA**  
**ALCOHOLIC BEVERAGE CONTROL BOARD**  
**AFFIDAVIT IN CONNECTION WITH POSTING LIQUOR LICENSE APPLICATION**  
Alaska Statutes: 04.11.260, 04.11.310

**POSTING AFFIDAVIT**

3 AAC 304.125 The public notice must be given within the 60 days immediately preceding the filing of the application.

I, the undersigned, being first duly sworn on oath, depose and say that:

1. a. Posting of application for a new Beverage Dispensary - Tourism liquor license  
for Host International, Inc. d/b/a Sleeping Lady Airport Lounge,  
located at Ted Stevens Anchorage International Airport, 5000 W. International Airport Rd., Anchorage, AK 99502  
(address and/or location)

OR

- b. Posting of application for transfer of a \_\_\_\_\_ liquor license  
currently issued to \_\_\_\_\_ whose business name (d/b/a)  
is \_\_\_\_\_ located at \_\_\_\_\_  
(address and/or location)

2. Has been completed by me for the following 10 FULL day period:

February 12, 2016 to February 22, 2016

\*\*\* Prior to the filing of said application, a true copy of the application was posted at the following described locations: (name and address of location)

- a. Location of premises to be licensed Ted Stevens Anchorage International Airport, 5000 W. International Airport Rd., Anchorage, AK 99502  
b. Other conspicuous location in the area Anchorage Post Office, 4141 Postmark Drive, Anchorage, AK 99530

3. I believe that with the approval of this application, population would not at one time exceed in the aggregate of one license of the type requested for population as provided by law. AS 04.11.400 (check one)

- a. ☐ a radius of five (5) miles of the proposed location.  
b. ☐ an incorporated city, organized borough or unified municipality.  
c. ☒ does not apply (application filed under AS 04.11.400(d)(e)(g) or transfer of license holder or location within an incorporated city or unified municipality or organized borough).  
d. ☐ established village.  
e. ☐ lodge license.  
f. ☐ common carrier.

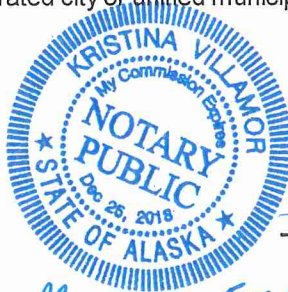

[Signature]  
(signature)

SUBSCRIBED and SWORN to me this 22nd day of February, 20 16.

[Signature]  
Notary Public in and for Alaska  
My commission expires: 12.25.18

*FYI: This page must be signed and notarized after  
you have posted your 3-page Liquor License application.*

STATE OF ALASKA  
DEPARTMENT OF TRANSPORTATION AND PUBLIC FACILITIES  
TED STEVENS ANCHORAGE INTERNATIONAL AIRPORT

ALASKA INTERNATIONAL AIRPORT SYSTEMS

CONCESSION AGREEMENT ADA-31641  
SUPPLEMENT NO. 5

THIS SUPPLEMENT to Concession Agreement ADA-31641 is entered by and between the State of Alaska, Department of Transportation and Public Facilities, Ted Stevens Anchorage International Airport, hereafter referred to as the "State", whose address is P.O. Box 196960, Anchorage, Alaska, 99519-6960, and Host International, Inc. whose address is 6905 Rockledge Drive, Bethesda, MD 20817-1109, hereafter called the "Concessionaire."

WITNESSETH:

WHEREAS, on the 16th day of December, 2009 the parties entered into a principal agreement, designated as Agreement No. ADA-31641 (the "Agreement") covering the following:

The non-exclusive right to prepare and sell food and beverage items for In-Terminal Consumption and State-approved merchandise items consistent with the particular concept for each Food and Beverage Facility in the terminals on the Ted Stevens Anchorage International Airport ("Airport"); and

WHEREAS, effective April 1, 2013, the parties entered Supplement No. 1, in which the State exercised the two (2)-year option to extend the Term to December 31, 2022, and which addressed Concessionaire's re-development and planned expansion of the food and beverage facility located in Room C2786 from the Legends Lounge to a Japanese-themed restaurant; adjusted the Annual Guarantee of Room C2786 to twenty-five dollars (\$25.00) per square foot per year; adjusted Percentage Fees for Room C2786 to ten percent (10%) for all sales; and amended applicable construction provisions and exhibits; and

WHEREAS, the parties entered Supplement No. 2, effective May 1, 2013, which addressed Concessionaire's development of an Airport Lounge Facility in Room C3156 including third floor mezzanine access; addressed the expansion of the Norton Sound Pre-Security seating and dining service area into Room C2052B; granted Concessionaire the option to extend the Term, in the Concessionaire's sole discretion, through September 30, 2028; set the Annual Guarantee of Room C3156 to twenty-five dollars (\$25.00) per square foot per year; set the Percentage Fees for Room C3156 to ten percent (10%) for all sales; and amended applicable construction provisions and exhibits; and

approximately 1,083 s.f. to approximately 1,159 s.f. Room C2164 consists of concession space and seating. The overall increase in square footage of Room C2164 reflects a relocation of the prior existing seating area and the addition of approximately 76 s.f. of seating. The doorway and wall which separate the concession space from the prior existing seating area will be closed off and finished by the State to the standards of Starbucks' finishes at no expense to Concessionaire.

Effective upon the date Room S1843, approximately 302 s.f., is delivered to Concessionaire, Room S1843 as depicted on Exhibit B (the "Baggage Claim Starbucks") is added to the Premises.

- II. The references in Supplement No. 4, Item Nos. II, IV and V, to "Article IV" of the Agreement are a typographical error and corrected to state "Article VI."
- III. Effective upon the date the Concessionaire opens the Baggage Claim Starbucks in Room S1843 for business, Article VI (Fees and Payments), Section A (Concession Rent and Fees), Subsection 1.g is added as follows:

"g. The Annual Guarantee for Food & Beverage Room S1843 is twenty-five dollars (\$25.00) per square foot per year."

- IV. Article IV, Section A2.g is added as follows:

Effective upon the date Concessionaire opens the Baggage Claim Starbucks in Room S1843 for business, Article VI (Fees and Payments), Section A (Concession Rent and Fees), Subsection 2.g is added as follows:

"g. Baggage Claim Starbucks:

Food, Beverages and Merchandise:  
Ten percent (10%) of Gross Revenues."

- V. Article XI (Construction, Remodeling, and Refurbishment), Section K. (Construction of Baggage Claim Starbucks in Room S1843) is added as follows and as shown on Exhibit B and described on Exhibits D and E:

"K. Construction of Baggage Claim Starbucks in Room S1843.

Concessionaire agrees to invest necessary funds as set forth in Article XI, Section B(2)(e) to construct a Baggage Claim Starbucks in Room S1843 which shall be operated by the Concessionaire.

The construction shall be in compliance with the State-approved Terminal Construction Standards, to include improvements. The Baggage Claim Starbucks space shall be delivered to Concessionaire by no later than

- IX. Exhibit D, as amended through Supplement No. 4, is hereby replaced and superseded by Exhibit D attached hereto.
- X. Exhibit E, as amended through Supplement No. 4, is hereby replaced and superseded by Exhibit E attached hereto.
- XI. The effective date of this supplement is October 1, 2015.

**ALL OTHER TERMS, PROVISIONS, AND COVENANTS REMAIN UNCHANGED.**



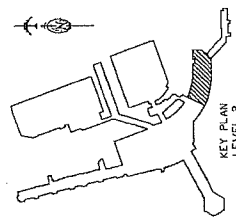

KEY PLAN:  
LEVEL 2

EXHIBIT B  
ADA NO: 31641  
SUPPLEMENT 5  
EXHIBIT DATE: OCTOBER 1, 2015

STATE OF ALASKA  
DEPARTMENT OF TRANSPORTATION  
AND PUBLIC FACILITIES

Ted Stevens  
**Anchorage**  
International Airport  
*"AeroVermont"*

15 32

SCALE IN FEET

83 Upper dwg  
PLOTTED OCT 23 2015 11:18:15

## AIRPORT LEASING

\\ENGINEERING\ENG-LIBRARIES\EXHIBITS\ANC\LEASING\CONCESSIONS\31641-HOST\SUP5\B3-Upper dwg OCT 23 2015 11 16 18

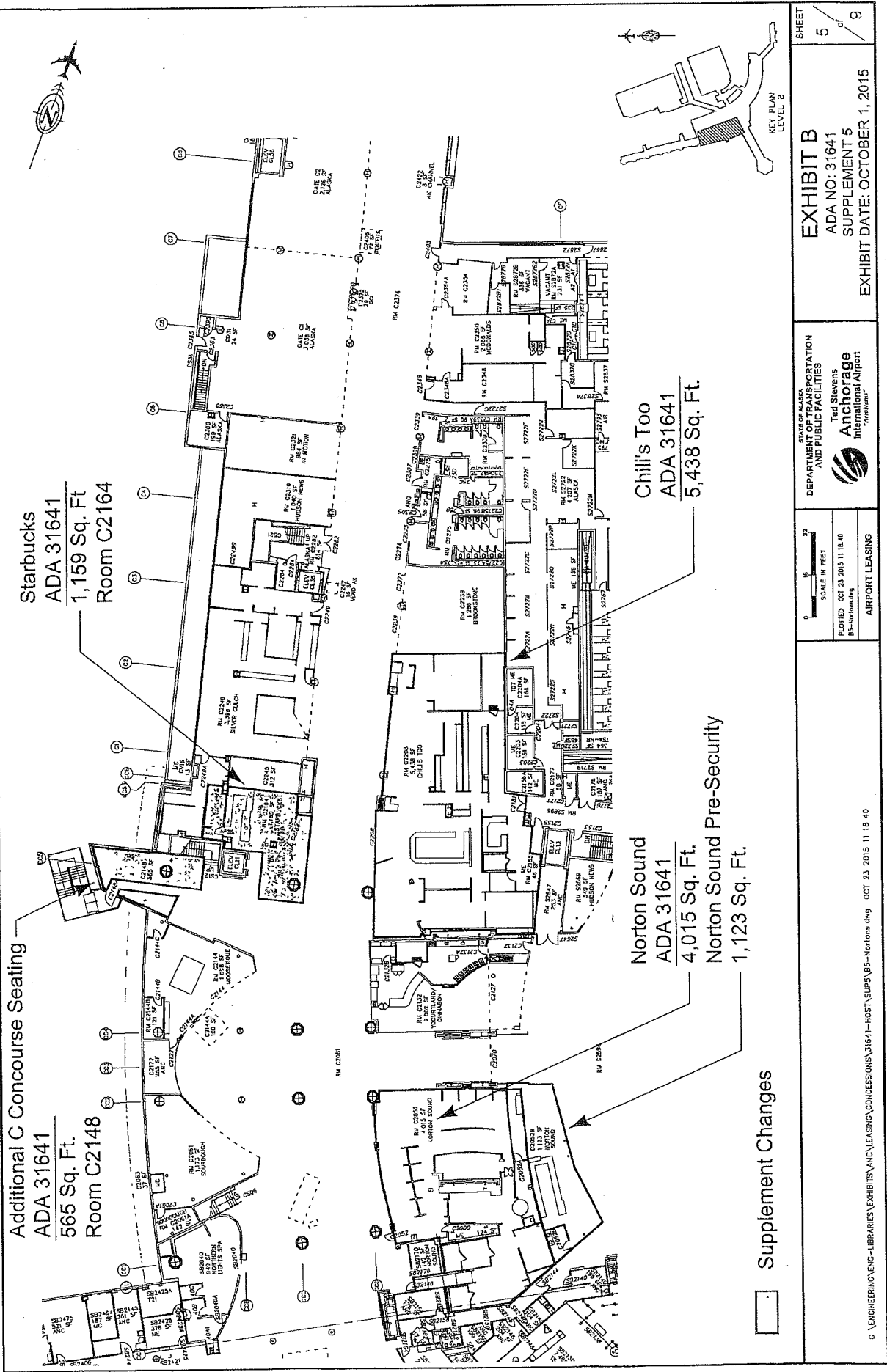

SHEET 5 of 9	<b>EXHIBIT B</b> ADA NO: 31641 SUPPLEMENT 5 EXHIBIT DATE: OCTOBER 1, 2015	STATE OF ALASKA DEPARTMENT OF TRANSPORTATION AND PUBLIC FACILITIES  Ted Stevens Anchorage International Airport "No Nemo" AIRPORT LEASING	C:\ENGINEERING\ENG-LIBRARIES\EXHIBITS\ANC\LEASING\CONCESSIONS\31641-HOST\SUPL\BS-Nortons.dwg OCT 23 2015 11:18:40
-----------------	--	--	---







C2052B	912 sf	Sit-down Dining – Norton Sound – Landside	TBD	1/31/2014
C2052B	211 sf	Additional seating	7/1/15	7/1/15
SB2750	2,072 sf	Local Bar – Humpy's (SF subject to confirmation by State and Host.)	3/27/2010	7/18/2010
		Total includes new additional seating of 268 s.f.	N/A	8/15/2014
C3156	2,000 sf	Airport Lounge	TBD	5/15/2016
C2781	498 sf	Sushi Kiosk	Mutually Agreeable Date	9/1/2015
C2148	565 sf	Additional C Concourse seating	10/1/15	10/1/15
S1843	302 sf	Starbucks Bag Claim	11/1/15	12/31/15

# **TED STEVENS ANCHORAGE INTERNATIONAL AIRPORT**

## **FOOD AND BEVERAGE CONCESSION AGREEMENT**

**ADA-31641  
Supplement No. 5**

### **EXHIBIT E Food and Beverage Program**

Concourse seating

#### *New Food and Beverage Space*

<u>Space</u>	<u>Size</u>	<u>Concept</u>	<u>Scope of Work</u>
C2052	4,015 sf	Norton Sound	Design and develop a seafood themed restaurant with a full service bar. Restaurant look and feel will be consistent with the rendering provided to the airport. The restaurant will be primarily on the secure side of the airport but will have a small area available on the landside – however, this landside area is contingent upon TSA approving the “Sally Port” device currently in use in an airport in Oregon. This device allows food/items to move from the secure side of the airport to the non-secure side (but will not allow items to flow from the non-secure side to the secure side).
C2052B	1,123 sf	Norton Sound Pre-Security Dining	Design and develop a Pre-Security restaurant dining service area.
SB2750	2,072 sf	Humpy's	Design and develop a Humpy's bar (a local establishment in downtown Anchorage). The facility will include a small kitchen, a bar and a seating area. The look and feel of the facility will be consistent with that of Humpy's. Space increased from 1,804 to 2,072 s.f. to accommodate expanded seating.
C3156	2,000 sf	Airport Lounge	Design and develop Airport lounge (e.g. wine bar with other amenities typically found at an airport lounge as agreed to by the State and Host), subject to access.
C2781	498 sf	Sushi Kiosk	Design and develop a Sushi kiosk.



THE STATE  
of **ALASKA**  
GOVERNOR BILL WALKER

Department of Commerce, Community,  
and Economic Development

ALCOHOLIC BEVERAGE CONTROL BOARD

550 West 7<sup>th</sup> Ave. Ste. 1600  
Anchorage, Alaska 99501  
Main: 907.269.0350  
TDD: 907.465.5437  
Fax: 907.334.2285

**ALCOHOL SERVER TRAINING CERTIFICATION**

As Required Under AS 04.21.025

By affixing my signature below:

1. As a licensee (a sole proprietor, partner or officer, director, shareholder, member of the entity to which license is issued), I certify that I have received alcohol server training or will attend alcohol server training within 30 days of application and my certification is currently valid.
2. As a licensee, I certify that all my agents and employees tasked with patron identification verification have received alcohol server training and their certification is currently valid.

**EXCEPTION:**

- ☒ As a Corporate/LLC licensee (entity), I certify that all agents and employees, who serve, sell or are otherwise responsible for the service/sale/storage of alcoholic beverages have received alcohol server training and their certification is currently valid. I further certify that certain shareholders/officers/director/members of the entity that are **not directly or indirectly responsible** for the service/sale/storage of alcoholic beverages are not alcohol server training certified and will not be required to be certified.

Licensee Signature: \_\_\_\_\_

A handwritten signature in blue ink, appearing to read "Jeffrey L. Poersch", written over a horizontal line.

Licensee Printed Name & Title: Jeffrey L. Poersch, Secretary

Date: 3/1/2016

STATE OF ALASKA  
ALCOHOL BEVERAGE CONTROL BOARD  
**Licensed Premises Diagram**

**INSTRUCTIONS:** Draw a detailed floor plan of your present or proposed licensed premises on the graph below; show all entrances and exits, and all fixtures such as tables, booths, games, counters, bars, coolers, stages, etc.

DBA: Sleeping Lady Airport Lounge

**PREMISES LOCATION:** Ted Stevens Anchorage International Airport, 5000 W. International Airport Road, Anchorage, AK 99502

Indicate scale by x after appropriate statement or show length and width of premises.

**SCALE A:** \_\_\_\_\_ 1 SQ. = 4 FT.      **SCALE B:** \_\_\_\_\_ 1 SQ. = 1 FT.

Length and width of premises in feet: 2,000 square feet

**Outline the area to be designated for sale, service, storage, and consumption of alcoholic beverages in red.**

**DO NOT USE BLUE INK OR PENCIL ON THIS DIAGRAM.** Please see attached floor plan diagram.

This image shows a full page of blank graph paper. The grid consists of small, equal-sized squares formed by thin black lines. There are 20 columns and 20 rows of squares, creating a total of 400 square units. The paper is otherwise completely empty, with no margins, text, or other markings.



PLOT DEFINITION	0.00	8 - dark GRAY	0.13	7 - WHITE	0.30	2 - YELLOW
	0.05	9 - light GRAY	0.15	1 - RED	0.40	4 - CYAN
	0.08	6 - MAGENTA	0.20	3 - GREEN	0.50	5 - BLUE

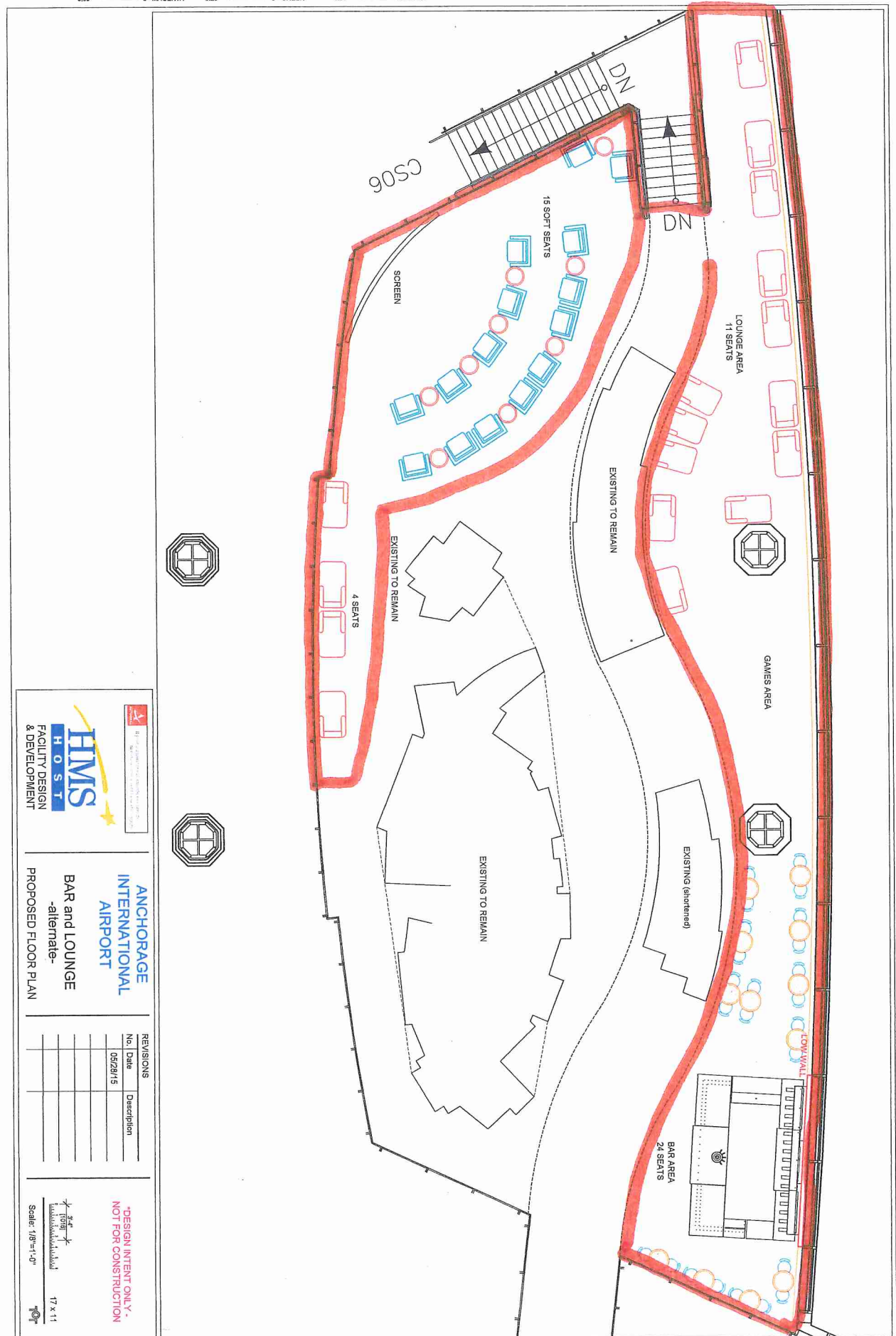

♦ ALASKA'S ♦

# SLEEPING LADY

WINE BAR & LOUNGE

**SLEEPING LADY LOUNGE**  
**TED STEVENS ANCHORAGE INTERNATIONAL AIRPORT**  
**PRESENTATION MATERIALS**  
**SEPTEMBER 17TH, 2015**



## KEY

- 1 OPEN TO BELOW
  - 2 BAR AREA
  - 3 DINING AREA
  - 4 EXISTING FLOORING TO REMAIN
  - 5 EXISTING PLANTER
  - 6 EXISTING ART DISPLAY
  - 7 LOUNGE SEATING WITH POWER, USB PORTS & HEADPHONE JACKS
  - 8 VIDEO GAME AREA
  - 9 RELOCATED KIOSK
  - 10 ELEVATOR
  - 11 18" SIDE TABLES
  - 12 42" HIGH SEATING
  - 13 MOVIE SCREEN
- ..... CUSTOMER JOURNEY
-  ADA SEATING

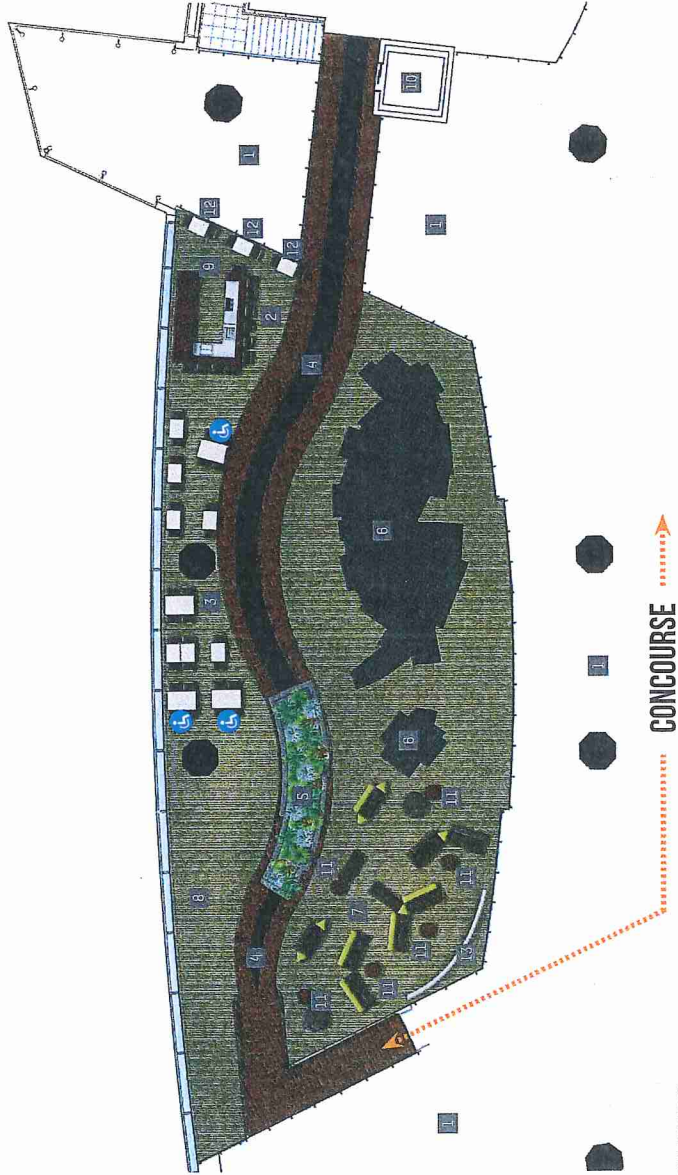

### SEAT COUNT

BAR SEATING	17
DINING SEATING	30
LOUNGE SEATING	34
<b>TOTAL</b>	<b>81</b>







BREAKFAST SERVED ALL DAY.  
FULL MENU SERVICE BEGINS AT 9:30 AM

## BREAKFAST

### TOTS & EGGS

any style with applewood smoked bacon,  
chicken apple sausage & sexy scallions  
8.29

### FRITTATA STYLE OMELETTE

with parmesan tots, assorted chz,  
grilled onions, tomato, applewood  
smoked bacon, smoked bbq trimmings  
8.99

### GRILCHZBACTOM & EGG

with fried eggs & cheddar chz,  
parmesan tots  
8.49

### WAFFLE & FRUIT

served with bacon or sausage, warm maple syrup  
0.00

### CAST IRON SKILLET HASH

with shirred eggs, grilled onions  
& parmesan tots, bbq trimmings,  
farmhouse cheddar chz  
8.49

## SNACKS

### ROSEMARY FRIED OLIVES & ALMONDS

7.49

### DIRTY CHIPS

bbq trimmings, green onions & scallion aioli  
8.29

### FRIED PORK & PICKLES FRIT

bbq bleu chz fondue  
7.49

### BAVARIAN PRETZELS

philly chz fondue  
7.99

### SMOKED PUB WINGS

pub hot sauce, bbq blue chz dipping sauce  
some 00.00  
more 00.00

Tax & Gratuity Not Included

## SOUPS & SALADS

all salads come with housemade

mini corn muffin with whipped honey butter

ROASTED CHICKEN & CAVATAPPI SOUP

Bowl 6.29

### P&P TTC

tuscan bean & turkey chili, farmhouse cheddar chz,  
shaved red onion & sexy scallions

Bowl 6.29

### WEDGEIE

iceberg wedgeie, hot house tomatoes, applewood  
smoked bacon, chopped egg, scallions, crumbled  
& bleu chz fondue, bacon vinaigrette  
7.99

### GASTRO COBB

baby field greens, paprika smoked turkey breast,  
applewood smoked ham, shredded farmhouse cheddar chz,  
chopped red onion, tomatoes, charred corn  
& green onion vinaigrette with fresh avocado aioli  
11.99

### HOT SMOKED SALMON SALAD

baby field greens, avocado slices, salmon,  
diced red onions, fried capers, pumpernickel, drizzle  
of lemon juice & extra virgin olive oil  
14.99

## BETWEEN BREAD

comes with parsley parmesan fries & housemade pickle

### GRILCHZBACTOM

on double cut toast

8.99

### SMOKED BEEF BRISKET

farmhouse cheddar chz, gastro sauce  
& slaw on a crisp baguette  
10.29

### SMOKED PAPRIKA TURKEY BREAST

lettuce, hot house tomato, applewood smoked bacon  
& spicy avocado butter on double cut toast  
10.29

### ARTISAN HAM & CHZ

applewood smoked ham, cheddar chz, whole grain  
mustard on a crisp baguette  
9.99

### ANGUS BURGER

lettuce, tomato & farmhouse cheddar on a brioche roll  
10.49

### SMOKED CHICKEN BAGUETTE

shredded chicken, bleu chz crumbles, grilled onions  
& gastro sauce on a crisp baguette  
10.29

## PUB SIDES

SKINNY CHEDDAR FRIES 3.99

MINI CORNBREAD MUFFINS 0.00

PARMESAN TATER TOTS 3.99

BAKED BEANS 0.00

VINEGAR COLE SLAW 3.29

## BBQ

comes with parsley parmesan fries, slaw  
& mini corn muffin with whipped honey butter

### SMOKED PORK SPARE RIBS

wet or dry  
half rack 17.99 full rack 00.00

### SMOKED 1/2 RACK PORK RIBS & 1/4 BBQ CHICKEN

hand carved on white bread, gastro bbq sauce  
16.99

### SMOKED 1/2 RACK OF RIBS, BEEF BRISKET & SMOKED SAUSAGE COMBO PLATE

00.00

### SMOKED 1/2 BBQ CHICKEN

14.99

### SMOKED BEEF BRISKET

hand carved on white bread, gastro bbq sauce  
15.99

### SMOKED PAPRIKA BBQ TURKEY BREAST

hand carved on white bread  
16.00

### SMOKED SAUSAGE PLATE

on white bread, gastro bbq sauce  
15.99

## LINKS

from SCATTOO'S

kansas city's finest

served on a bavarian pretzel roll with  
grilled onions, spicy whole grain mustard,  
housemade pickle & parsley parmesan fries

PORK BRATS.....9.99

BEEF FRANKFURTER.....8.99

TURKEY APPLE SAUSAGE .....0.00

SMOKED ITALIAN SAUSAGE .....0.00

### GASTRO HOME WRECKER

foot long all beef dog with grilled onions,  
philly chz fondue on a crisp baguette  
9.99

a Pickled Pleasure

## PUB PLATES

comes with mini corn muffin with whipped honey butter

### FISH & CHIPS

spicy lemon aioli, slaw, skinny fries  
14.99

### STEAK FRITES

12 oz. kansas city ribeye, parmesan parsley fries,  
tarragon butter  
market price

### DIRTY MAC N' CHZ

bbq trimmings, green onions & cheddar panko  
12.99

## SLIDERS

### ANGUS BEEF

grilled onions, tomato & philly chz fondue  
12.99

### PAPRIKA SMOKED TURKEY

tomato, applewood smoked bacon & spicy avocado  
11.99

### PORK & PICKLE

pulled pork, bbq sauce, bread & butter pickles,  
vinegar cole slaw & shaved onions  
11.99

WE COOK WITH WINE.  
SOMETIMES WE EVEN  
ADD IT TO THE FOOD.

- W.C. FIELDS

## SWIRLZ

### DESSERT WAFFLE

topped with ice cream & drizzled with caramel  
0.00

### ICE CREAM SANDWICHES

homemade chocolate chip cookies with vanilla ice cream,  
powdered sugar & caramel sauce  
5.99

### CHOCOLATE CHIP COOKIES

3 homemade...SWEET!

0.00

\*NOTICE: Consuming raw or undercooked meats, poultry, seafood, shellfish, or eggs may increase  
your risk of foodborne illness, especially if you have certain medical conditions. This facility may use  
wheat, egg, soybean, milk, peanuts, tree nuts, fish and shellfish. Please speak  
to the manager on duty regarding any allergen-related issues.



BEER IS PROOF  
THAT GOD LOVES US  
AND WANTS  
US TO BE HAPPY.

- BENJAMIN FRANKLIN

## PORK & PICKLE BEERS ON TAP

**BOULEVARD TANK 7 FARMHOUSE** MO, USA, 8.0% ABV  
light to medium bodied with an earthy, spicy, grapefruit aroma  
and a soft, sweet malt flavor

**BOULEVARD SINGLE-WIDE IPA** MO, USA, 5.7% ABV  
flowery, with a grapefruit hop aroma, caramel  
malt flavor & dominant hop bitterness

**BOULEVARD SEASONAL** MO, USA

ask your server for our current Boulevard Brewing flavor

**FAT TIRE AMBER ALE** CO, USA, 5.2% ABV  
with toasty, biscuit-like malt flavors coating  
in equilibrium with hoppy freshness

**STELLA ARTOIS** Belgium, 5.2% ABV  
refreshing with a malty middle & crisp finish,  
delivering full flavor with just a hint of bitterness

**SAM ADAMS BOSTON LAGER** MA, USA, 4.9% ABV  
smooth-bodied, full-flavored & robust. Made using  
only the four classic brewing ingredients

**GOOSE ISLAND SEASONAL** IL, USA

ask your server about our current Goose Island offering

**SHOCK TOP WHEAT** MO, USA, 5.2% ABV  
Belgian-style wheat ale, fresh and fruity on the nose.

Look for fresh flavors of orange, lemon peel and coriander

**HOEGAARDEN** Belgium, 4.9% ABV

Subtle flavors of coriander and orange peel  
with a light hop flavor and a crisp, fruity, refreshing taste

**ANCHOR BREKLE'S BROWN ALE** CA, USA, 6.0% ABV  
Coppery brown in color with an unusual depth of flavor and hints of  
citrus, making for a richness and complexity without heaviness

A lively bouquet with elements of citrus and a beautifully balanced  
flavor with a hint of spiciness and a round mouthfeel.

**SAM ADAMS SEASONAL** MA, USA

Ask your server about our seasonal Sam Adams offering

**BUD LIGHT** MO, USA, 4.2% ABV  
delicate aromas of malt & hops. Subtle fruit  
& citrus taste notes with a clean finish

## SPECIALTY BOTTLES

**DELIRIUM TREMEMS** Belgium, 8.5% ABV  
using three different kinds of yeast. It is a full bodied  
& alluring, fruitily-hoppy, blond specialty

**DUVEL RED BLONDE ALE** Belgium, 8.5% ABV  
fruity & dry on the nose, with a dry but still  
alcohol-sweet flavor and a pronounced hop aroma

**LAGUNITAS IMPERIAL STOUT** CA, USA, 9.9% ABV  
dark & thick, highly roasted malted barley, & plenty of it,  
give the beer uncommon richness & smoky, roasty depth

**LEFT HAND MILK STOUT** CO, USA, 6.0% ABV  
the milk sugar in this dark beer adds a well rounded  
sweetness & makes it an outstanding, year 'round stout

**ROGUE DEAD GUY ALE** OR, USA, 6.6% ABV  
using a proprietary Pacman ale yeast, its deep honey color  
carries a malty aroma & a rich hearty flavor

**FREE STATE AD ASTRA ALE** KS, USA, 5.6% ABV  
a full bodied Ale that uses a hint of hops to balance the  
sweetness that comes from its three different malt varieties

**TALLGRASS ETHOS IPA** CO, USA, 6.8% ABV  
big, bright & beautiful, twice dry-hopped resulting in complex  
flavors but without overwhelming the senses

### ANGRY ORCHARD

**CRISP APPLE CIDER** OH, USA, 5.0% ABV  
sweet yet subtle dryness for a balanced cider taste finishing  
with fresh apple & a slightly sweet flavor

**SOUTHAMPTON DOUBLE WHITE** NY, USA, 6.6% ABV  
done in the style of a traditional Belgian Witbier, it's delicate,  
balanced and as refreshing as the original, but more intense

**OMMEGANG RARE VOS** NY, USA, 6.5% ABV  
a golden, traditional café-style ale, mellow, fruity and spicy

**GREEN FLASH WEST COAST IPA** CA, USA, 7.3% ABV  
a menagerie of hops layered throughout the brewing  
process, with pine and citrus notes and a floral aroma

**OMISSION PALE ALE** OR, USA, 5.8% ABV  
bold and hoppy, an American Pale Ale bold in color  
with a floral aroma and caramel malt body

### OSKAR BLUES TEN FIDY

**IMPERIAL STOUT (CAN)** CO, USA, 10.5% ABV  
loaded with flavors of chocolate-covered caramel  
and coffee underneath a smooth blanket of malt

**BOULEVARD WHEAT BEER (CAN)** MO, USA, 4.4% ABV  
a slightly cloudy, light-bodied, straw colored beer with a sweet,  
breadly malt flavor, low hop bitterness and a hint of citrus

### NEW BELGIUM 1554

**ENLIGHTENED BLACK ALE** CO, USA, 5.6% ABV  
chocolate flavors with a bright acidity, toasted notes and a round  
sweetness with spicy undertones and lingering fruit acidity

## LARGE FORMAT BOTTLES

(22 OZ.)

**SAISON DUPONT** Belgium, 6.5% ABV  
this is a beautifully balanced, complex beer  
that has a refreshing fruitiness and long, dry finish

**CHIMAY GRAND RESERVE BLUE** Belgium, 9.0% ABV  
yeast on the nose with a light, rosy touch, a flavor  
that accentuates the aroma with a touch of roasted malt

### BOULEVARD

**LONG STRANGE TRIPEL** MO, USA, 9.0% ABV  
full bodied with a fruity aroma of bananas & hint of toffee,  
ending with a citrusy hop flavor and bitterness

## ADDITIONAL BOTTLES

**BUDWEISER • MICHELOB ULTRA**

**CORONA • HEINEKEN**

**MILLER LITE • PABST BLUE RIBBON**

**O'DOUL'S N.A.**

## WINES

By The Glass

**STERLING VINTNER'S COLLECTION**  
chardonnay

**SONOMA-CUTRER**  
**RUSSIAN RIVER RANCHES**  
chardonnay

**BV CENTURY CELLARS VINEYARD SELECT**  
chardonnay

**CHATEAU STE. MICHELLE**  
riesling

**KIM CRAWFORD**  
sauvignon blanc

**ECCO DOMANI**  
pinot grigio

**TERRAZAS DE LOS ANDES**  
malbec

**RED ROCK**  
merlot

**MIRASSOU**  
pinot noir

**BV CENTURY CELLARS VINEYARD SELECT**  
cabernet sauvignon

**KORBEL**

brut champagne 187 ml

## CRAFT COCKTAILS

**PICKLED WATERMELON MARGARITA**  
1800 silver, muddled watermelon, agave nectar,  
lime juice, pickled watermelon rind

**ABSOLUT BLOSSOM**  
absolut citron, elderflower liqueur,  
fresh lime juice & simple syrup

### MICHELADA

Special blend of assorted peppers, Worcestershire sauce,  
tomato juice, lime juice, with a salt rim topped with Corona

### DRUNKEN BERRY ICED TEA

Firefly Sweet Tea Vodka, fresh brewed iced tea, lemon juice,  
shaken and topped with drunken berries

### HANGAR ONE CHIPOTLE MARY

hangar one chipotle vodka, spicy bloody mary mix  
with celery, fresh lime an olive and grape tomato

A FINE BEER MAY BE JUDGED  
WITH ONLY ONE SIP,  
BUT IT'S BETTER TO BE  
THOROUGHLY SURE.

- CZECH PROVERB

## SPIRITS

**VODKA**  
Grey Goose, Absolut, Absolut Citron,  
Ketel One, Ketel One Orange, Tito's,  
Hangar One Maine Wild Blueberry,  
Hangar One Chipotle, Smirnoff

**GIN**  
Hendrick's, Tanqueray,  
Beefeater

**RUM**  
Sammy's Beach Bar Rum,  
Malibu, Captain Morgan,  
Bacardi Superior

**TEQUILA**  
Patrón Silver, Maesiro Dobel,  
1800 Silver, 1800 Reposado,  
Jose Cuervo Gold

**SCOTCH**  
Glenfiddich 15 Year Old,  
Johnnie Walker Black, Dewar's

**BOURBON & WHISKEY**  
Woodford Reserve, Jack Daniel's  
Maker's Mark, Crown Royal,  
Jameson Irish Whiskey, Jim Beam

### COGNAC & LIQUEURS

Hennessy VS, Grand Marier, Southern Comfort, Kahlua,  
Disaronno Originale, Chambord, Agavero, Baileys,  
St. Germain, Martini & Rossi



## TOURISM STATEMENT

### Host International, Inc. d/b/a Sleeping Lady Airport Lounge New Liquor License

Global restaurateur Host International, Inc. (“Host”) is a world leader in creating dining for travel venues. Host operates in more than 100 airports around the globe, including the 20 busiest airports in North America. In order to encourage tourism, Host will be bringing the freshest ingredients into Ted Stevens Anchorage International Airport with *Sleeping Lady Airport Lounge*, a Host original concept that was designed specifically for this airport. *Sleeping Lady Airport Lounge* marries the freshest ingredients for a menu loaded with culinary creations. It will also embrace the finest in local brewing, and offer an array of top shelf and signature cocktails. It will boast a 125 inch screen and movie theater seating so passengers can relax and unwind. The movie theater will play major sporting events and, during the summer, will loop in Alaskan themed educational shows. There will also be interactive Alaskan themed video games for passengers to enjoy. Finally, travelers frequenting the Lounge will be treated to a spectacular view of Mount Susitna, or *The Sleeping Lady*, for which the Lounge was named.

The addition of *The Sleeping Lady Airport Lounge* at ANC is a tremendous opportunity to give travelers a true taste of what Alaska has to offer. It’s an uncommon airport destination that will draw and retain famished travelers with its compelling portfolio of food and beverage offerings.