



ASSEMBLY WORK SESSION ON ANCHORAGE PARK AND RECREATION'S  
**CIP/CIB DEVELOPMENT  
& THE STATE OF PLAY**

FEBRUARY 7, 2025

# AGENDA

1. Capital Improvement Program (CIP) and Budget (CIB)
2. State of Play: Evidence Based Strategies



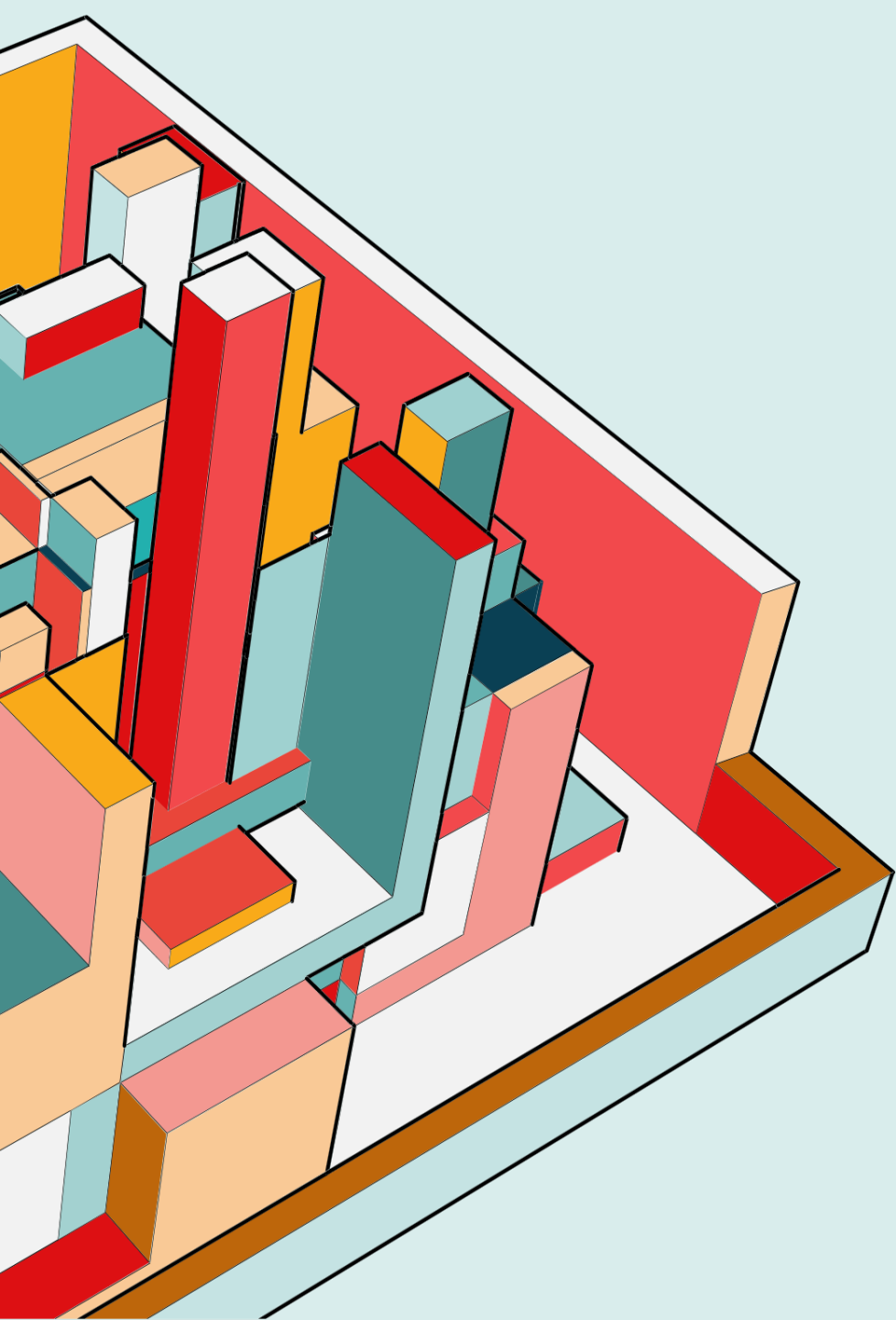

# CAPITAL IMPROVEMENT PROGRAM AND BUDGET

Getting a lot done with a (*relatively*) little bond

# HOW ITS GONE

A successful bond in the past focused on the following:

- **Spread the Love:** Spread out capital improvement projects to engage voters across the MOA
- **Leverage Outside Funds:** Anchorage Park Foundation, legislative grants and AMATS
- **Community Engagement:** Volunteers, Cooperative Use Agreements, and Community Advocates elevated projects as quick wins
- **Health, Safety and Welfare:** What needs to get done? Has a bridge collapsed? Is an asset significantly past its useful life?



# HOW IT'S GOING

Today we formalize these focus areas and blend them with the PM&E scoring matrix model to **facilitate transparency and record need.**

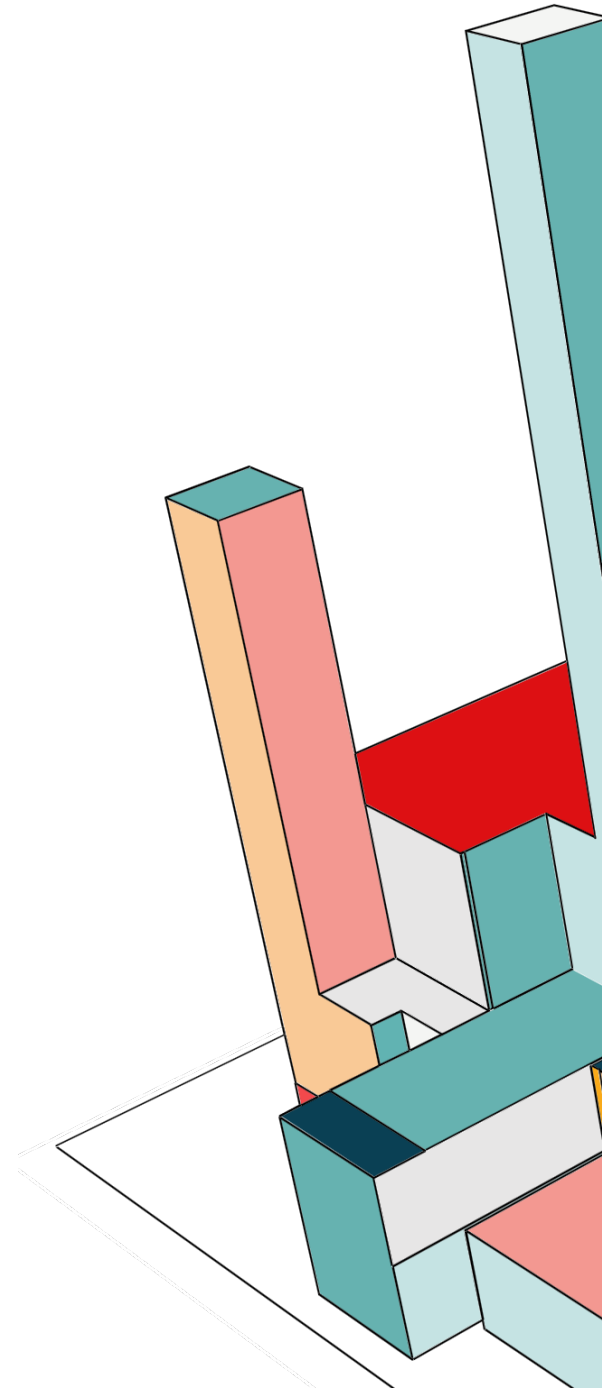



# CREATING PARAMETERS AND GUIDES

### 2026 Proposed Scoring Matrix for Capital Improvement Projects

Each category to be scored from 0 to 10 points based on how well the project aligns with that criterion. The scores can then be totaled to provide an overall score for each project. This scoring matrix not only helps internal staff in evaluating projects but can also be transparently communicated to the public to justify funding priorities based on community needs and support. Last updated 12/27/2024, to be more consistent with PM&E Scoring Criteria.

#### Consistency with Adopted Plan (PM&E #9)

Category: **Public Process and Opinion** | Points: 0-10

- 10 points: Fully aligns with adopted master plans, strategic plans, or site plans.
- 7 points: Partially aligns with adopted plans or addresses identified priorities.
- 4 points: Limited alignment with existing plans.
- 0 points: Does not align with any adopted plans.

#### Public Support (PM&E #2)

Category: **Public Process and Opinion** | Points: -5 to 5

- 5 points: Strong public advocacy with overwhelming community support (e.g., letters from councils or organizations, challenge grant project).
- 3 points: Moderate public support with minimal resistance.
- 0 points: Some support but notable objections exist.
- -5 points: Significant public opposition.

#### Support of the Project by Administration and Parks and Recreation Department (PM&E #3)

Category: **Public Process and Opinion** | Points: -5 to 5

- 5 points: This project has virtually unanimous support
- 2 points: Some members of the staff support this project
- 0 points: The administration is neutral towards the project
- -2 points: The Administration and/or staff have a low opinion of the project
- -5 points: The administration and staff are opposed to the project

#### Support of Project by Community Council and Elected Officials (PM&E #4)

Category: **Public Process and Opinion** | Points: -5 to 5

- 5 points: The project has virtually unanimous support and is identified as a top priority in a recent community survey (scores top 3 of overall requests on the CIP CC Survey).
- 3 points: The project has some support and is mentioned in community survey (CIP CC) as a desired improvement.
- 0 points: No evidence of community survey support through CIP.
- -3 points: There is considerable opposition by a majority of the community council and or elected officials.
- -5 points: There is overwhelming opposition to the project

#### Operation and Maintenance (O&M) Impact (PM&E #10)

Category: **Budget and Operations** | Points: -5 to 15

- 15 points: Significantly reduces O&M costs.
- 10 points: Minimally increases O&M efficiency or has neutral impact.
- 0 points: No O&M cost impact anticipated.
- -5 points: Substantially increases O&M costs.

#### External Funding or Partnerships

Category: **Budget and Operations** | Points: 0 to 5

- 5 points: Existing external funding or partnerships. In addition to funding, this includes existing or proposed maintenance agreements with user groups and stakeholders.
- 3 points: Moderate potential for external support.
- 1 points: Limited prospects for external contributions.
- 0 points: No identified opportunities for external funding.

#### Environmental Impact

Category: **Infrastructure and Environment** | Points: 0 to 10

Points: 0-10

2025 CIP- the matrix was completed by internal staff.

2026 CIP - the matrix will include staff from PM&E as well as Anchorage Park Foundation



# CATEGORIES FOR PRIORITIZATION

The Scoring Matrix Categories include the following:

- Consistency with adopted plans (0-10)
- Public support (-5 to 5)
- Support of the project by administration and Parks and Recreation Department (-5 to 5)
- Support of project by Community Council and elected officials (-5 to 5)
- Operations and maintenance (-5 to 15)
- External funding or partnerships (0 to 5)
- Environmental impact (0 to 10)
- Support for existing infrastructure (0 to 10)
- Property ownership (0 to 10)
- Severity of need (0 to 10)
- Population served and park type (0 to 5) - AR 2024-323(S)



# LET'S WALK THROUGH IT – THREE CASE STUDIES

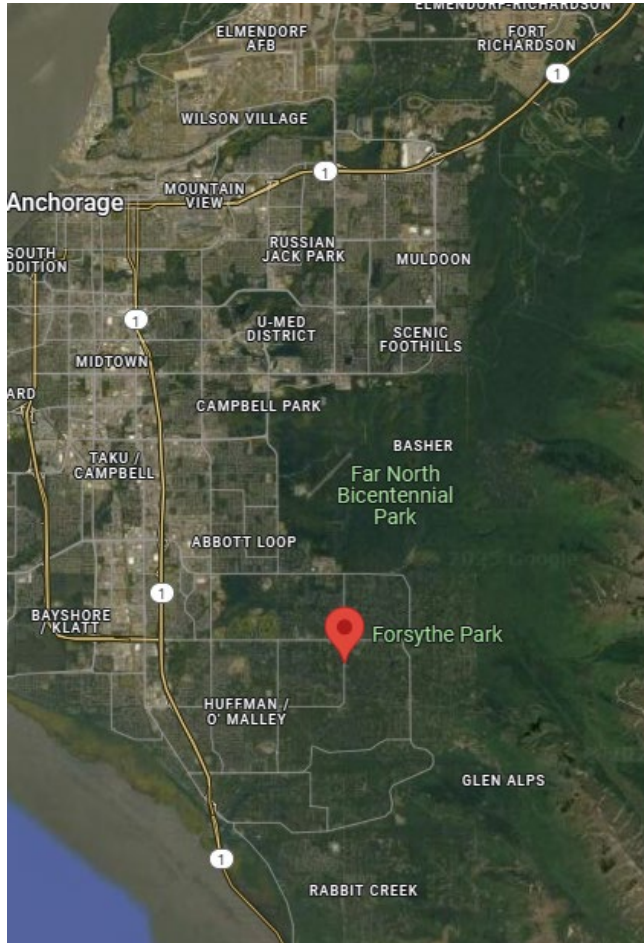

FORSYTHE PARK

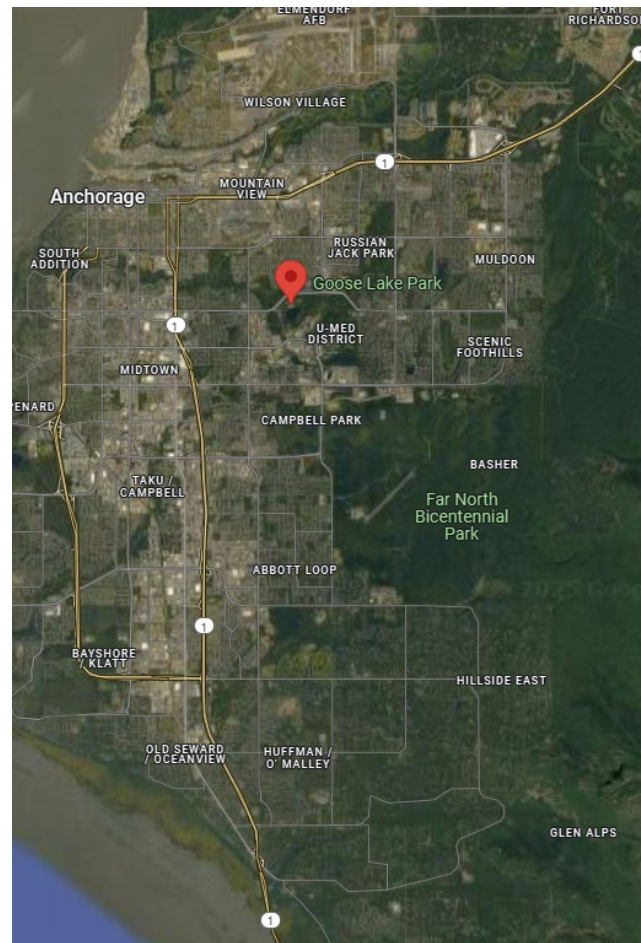

GOOSE LAKE PARK

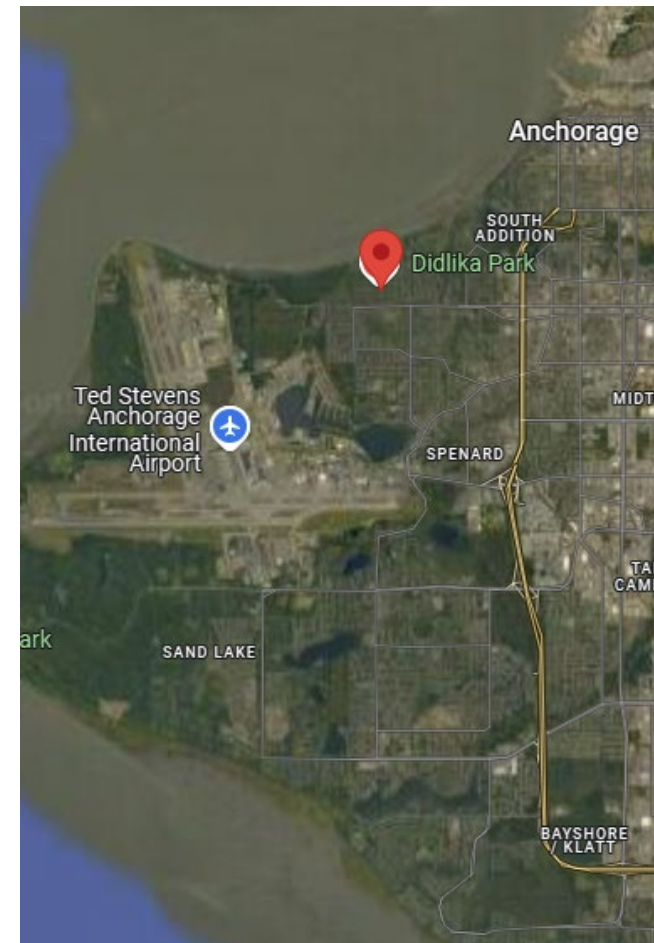

DIDLIKA PARK



# LET'S WALK THROUGH IT – FORSYTHE PARK

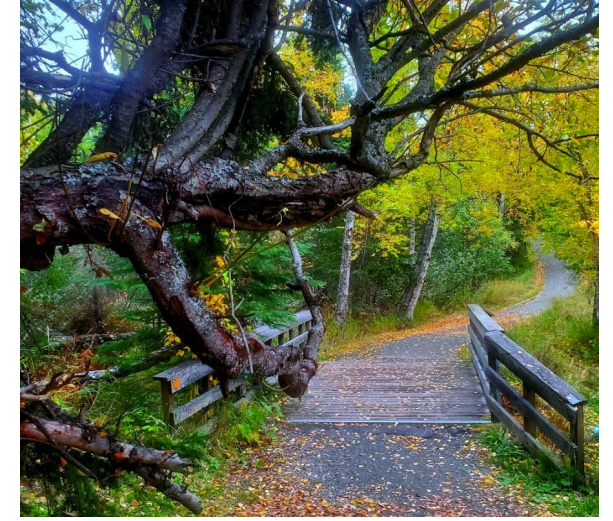
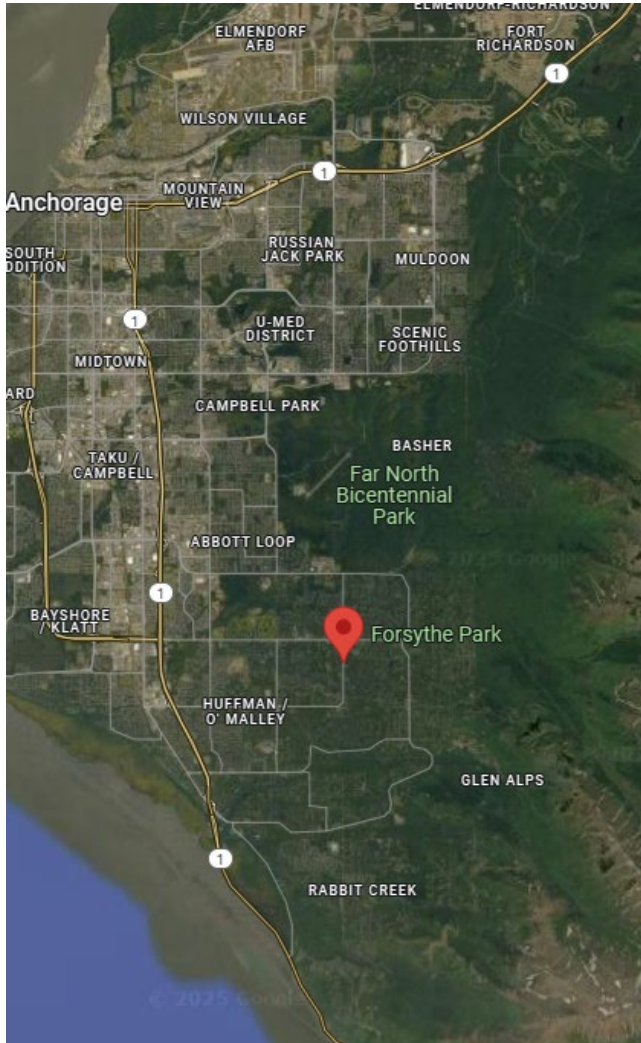

- Neighborhood Use park in South Anchorage,
- Rehab of Bridge, Trail, Wayfinding
- Playground equipment in fair condition
- Tennis court needs resurfacing, 2024 CC CIP request for pickleball

# LET'S WALK THROUGH IT – FORSYTHE PARK

Park Name	Score	Comments
Consistency with adopted plan (0-10)	5	No recent or existing plan
Public support (-5 to 5)	5	Letters of support and CC CIP Survey
Support of project by admin and staff (-5 to 5)	5	Yes
Support of project by CC and elected officials (-5 to 5)	5	Yes, ranked 14 by Hillside CC on 2024 CC CIP Survey
O&M impact (-5 to 15)	15	New bridge and trail facilities would greatly improve winter Operations for snow removal
External funding or partnerships (0 to 5)	0	None currently identified
Supports existing infrastructure (0-10)	10	Improvements focus on existing facilities, playgrounds and trail systems
Environmental impact (0 to 10)	5	Construction would likely have small impacts on natural areas
Property ownership (0 to 10)	10	MOA Owned
Severity of need (0 to 10)	10	Bridge, trails, playground, and courts in need of rehabilitation or repair.
Population served and park type (0 to 5)	2	Neighborhood-Use, low population density
<b>TOTAL SCORE</b>	<b>73</b>	-

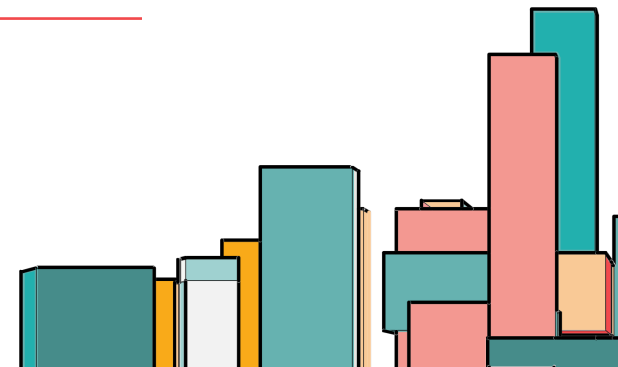



# LET'S WALK THROUGH IT – GOOSE LAKE PARK

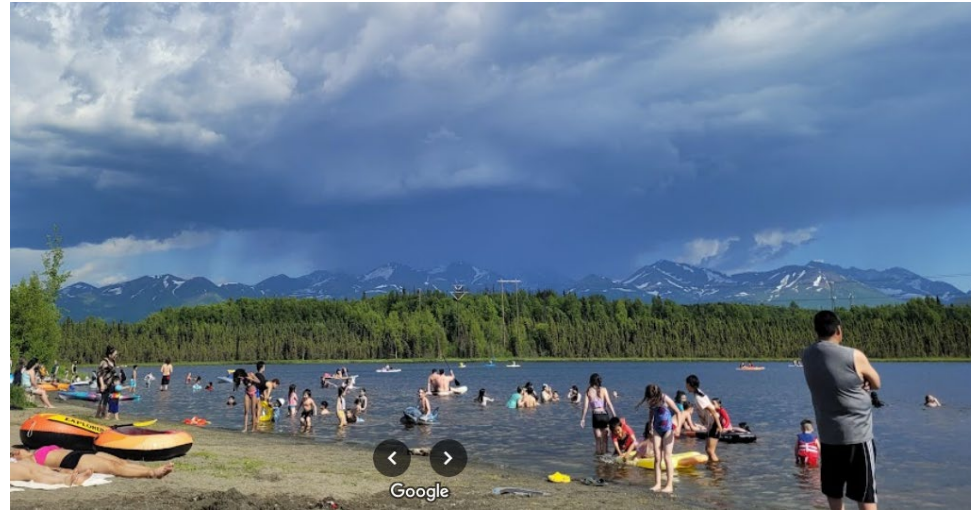
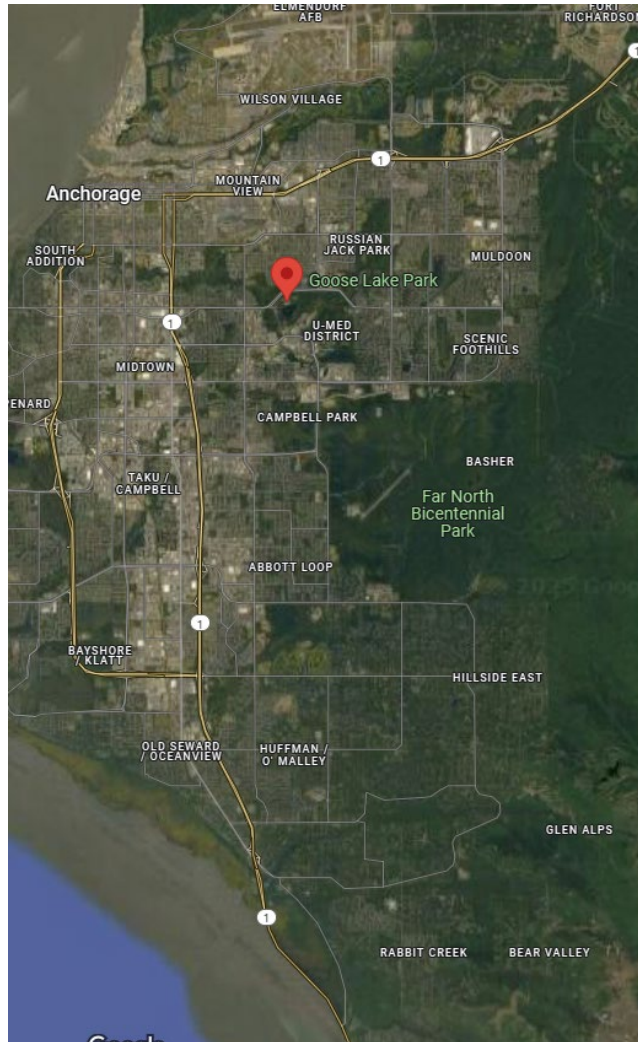

- Community-use park in U-Med District of Anchorage
- Hosts Polar Bear Plunge, Haunted and Enchanted, and major trailhead for Chester Creek Trail
- Goose Lake Facility rehabilitation/redevelopment
- Trail and wayfinding rehabilitation
- Playground equipment is outdated, accessibility concerns exist
- Parking lot and basketball court need to be resurfaced
- Multiple 2024 CC CIP Surveys as priority

# LET'S WALK THROUGH IT- GOOSE LAKE PARK

Park Name	Score	Comments
Consistency with adopted plan (0-10)	8	Older, needs updating
Public support (-5 to 5)	5	UAA Advocacy, letters of support and on two CC CIP Survey
Support of project by admin and staff (-5 to 5)	5	Yes, very popular park that needs updated amenities
Support of project by CC and elected officials (-5 to 5)	5	Yes - ranked in top 6 on 2024 CC CIP Survey
O&M impact (-5 to 15)	15	Goose Lake facility would be removed/replaced/rehabilitated based on public input needs
External funding or partnerships (0 to 5)	3	Informal partnerships currently in development
Supports existing infrastructure (0-10)	5	Construction would likely have small impacts on natural areas
Environmental impact (0 to 10)	10	Supports existing facility, playgrounds and trail systems
Property ownership (0 to 10)	10	MOA owned
Severity of need (0 to 10)	10	Current Goose Lake facility "yellow tagged", parking lot improvements needed, aging playground, shore bank repair needed along trail, basketball court needs repair
Population served and park type (0 to 5)	5	Community-use designation, serves diverse communities (esp. summer)
<b>TOTAL SCORE</b>	<b>81</b>	-





# LET'S WALK THROUGH IT – DIDLIKA

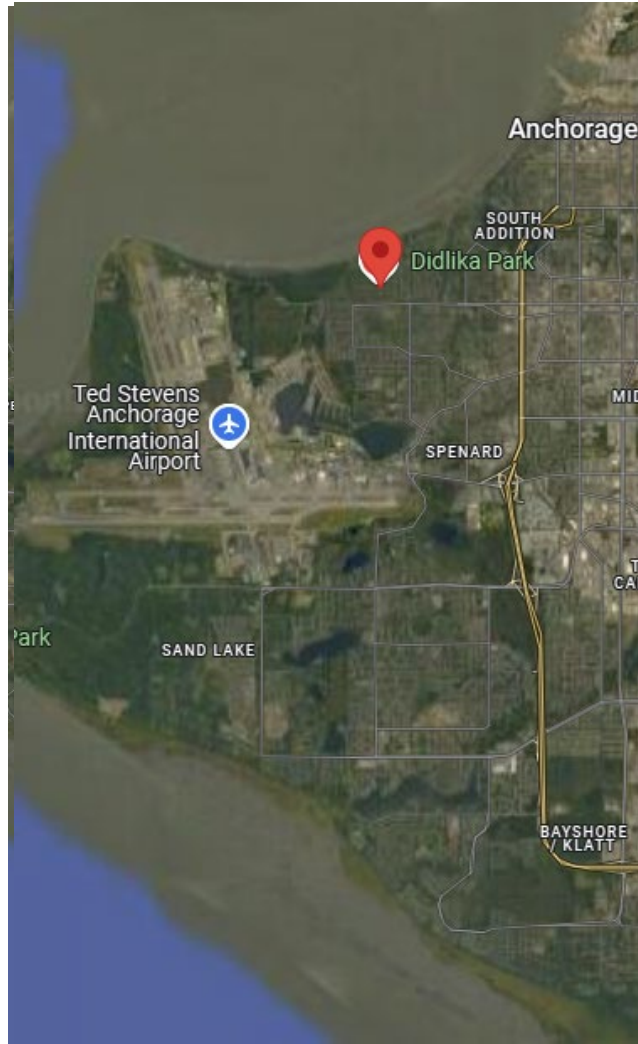

- + Neighborhood park in NW Anchorage
- + Playground equipment and surfacing needs to be replaced
- + 2024 CC CIP Survey as request for redevelopment



# LET'S WALK THROUGH IT- DILDIKA PARK

Park Name	Score	Comments
Consistency with adopted plan (0-10)	5	Older site plan
Public support (-5 to 5)	0	On CIP Survey, but unranked
Support of project by admin and staff (-5 to 5)	5	Yes
Support of project by CC and elected officials (-5 to 5)	5	Yes
O&M impact (-5 to 15)	10	Small playground, but rehab would have positive impact on O&M
External funding or partnerships (0 to 5)	0	No external funding currently identified
Supports existing infrastructure (0-10)	10	Construction would likely have small impacts, but development is on poor soils increasing construction costs
Environmental impact (0 to 10)	10	Project focus is on rehabilitation of existing features.
Property ownership (0 to 10)	10	MOA owned
Severity of need (0 to 10)	8	Playground and surfacing need rehab, but pavilion in fair condition.
Population served and park type (0 to 5)	3	Neighborhood-use, supports single family zoned neighborhood
<b>TOTAL SCORE</b>	<b>61</b>	-



# LET'S WALK THROUGH IT – THREE CASE STUDIES

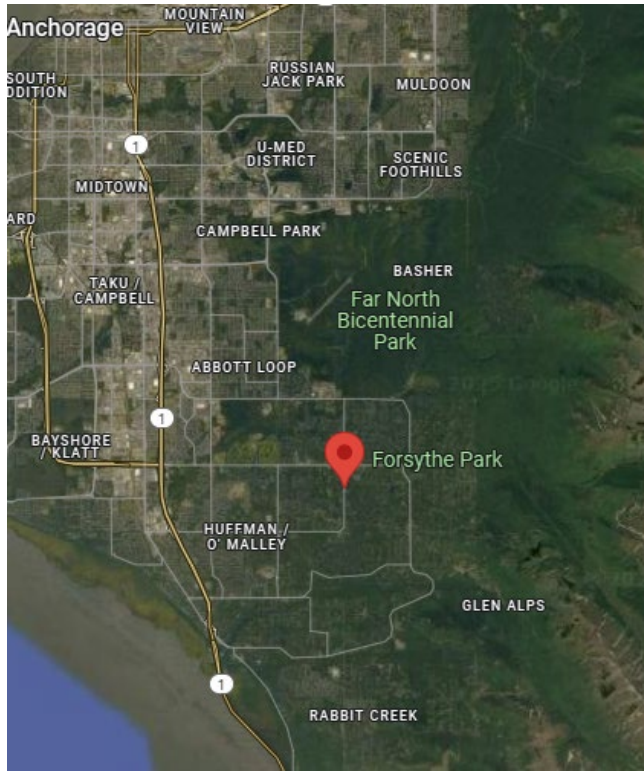

FORSYTHE PARK

73

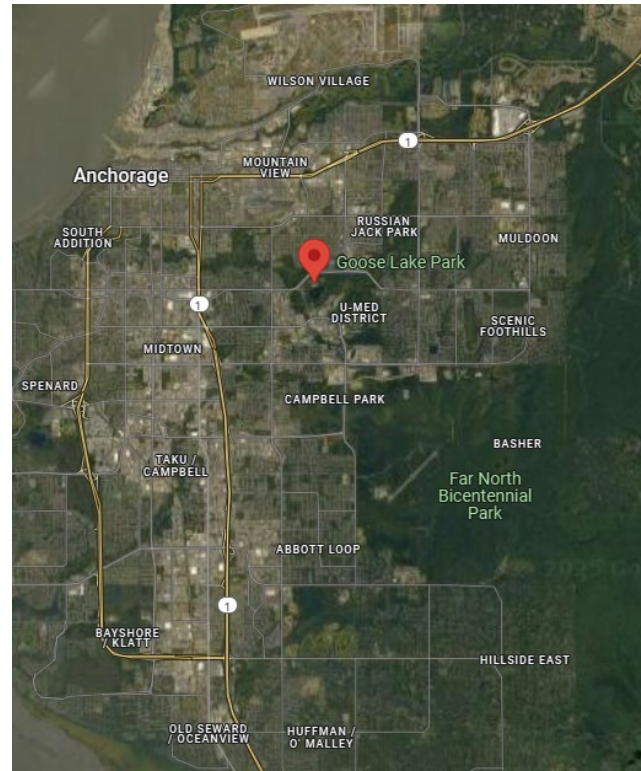

GOOSE LAKE PARK

81

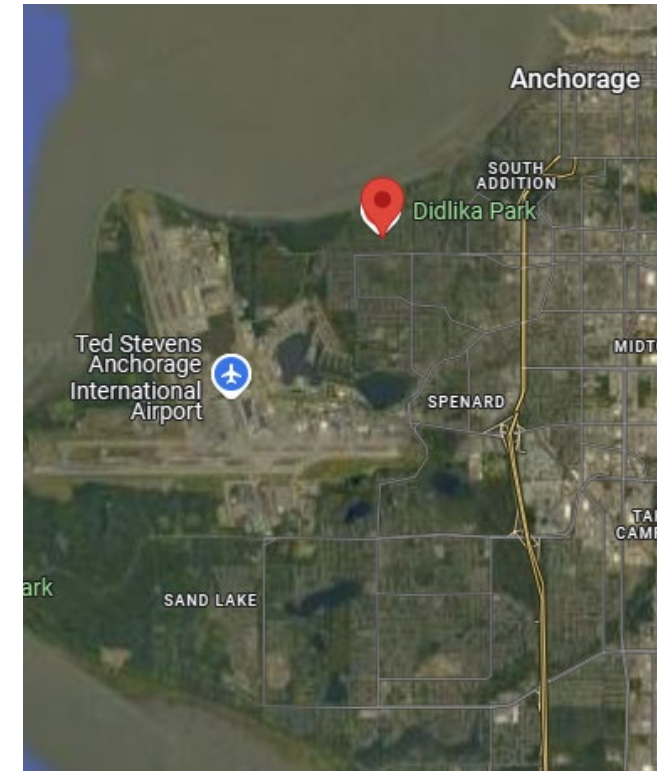

DIDLIKA PARK

61

# HOW DOES SOMETHING GET ON “THE LIST?”

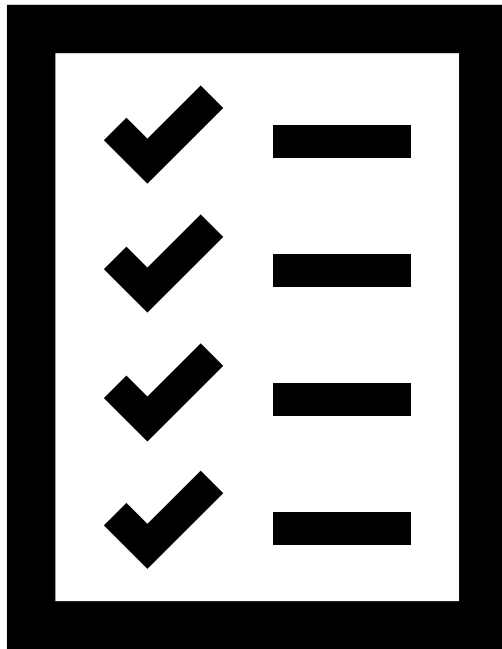

- [Community Council CIP Survey](#)
- [Challenge Grant application](#)
- Letter(s) from community organization
- Mayoral priority
- Brought forth by staff
- Health, Safety, and Welfare (HSW)
- Match/grant opportunities
- [Park Improvement Proposal](#)
- Other?

# PROGRESS RELIES ON ADAPTATION



Needs, priorities, and conditions change.

Because of this, the CIP Scoring Matrix and its measurements are considered working documents.

A working document is never static; it grows and improves through iteration and insight.

*We welcome questions and feedback to make this process better.*





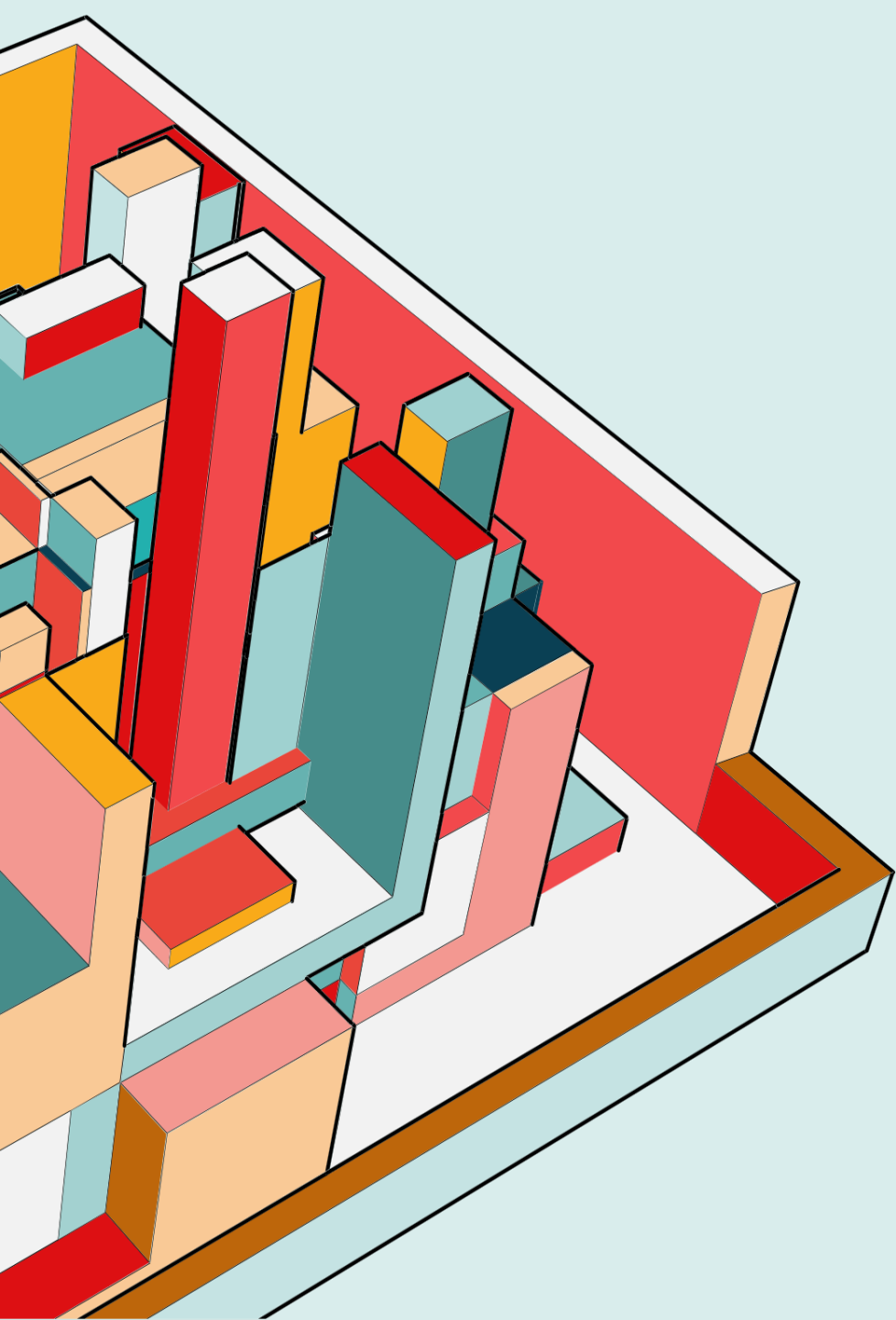

# **THE STATE OF PLAY**

Evidence-based strategies



# STATE OF PLAY IN THE MOA

- Inspired by the 2006 Park Plan, the Inclusive Play Guide, and our evolving perceptions of play, development, and inclusion our department developed “The State of Play in the MOA: A Strategic Plan for Inclusive Play” in 2018.
- Strategic Plan Goals: “We aim to have all community use playgrounds be inclusive, every community council have an inclusive playground and all playgrounds rank a final park score of seven or below by 2030.”

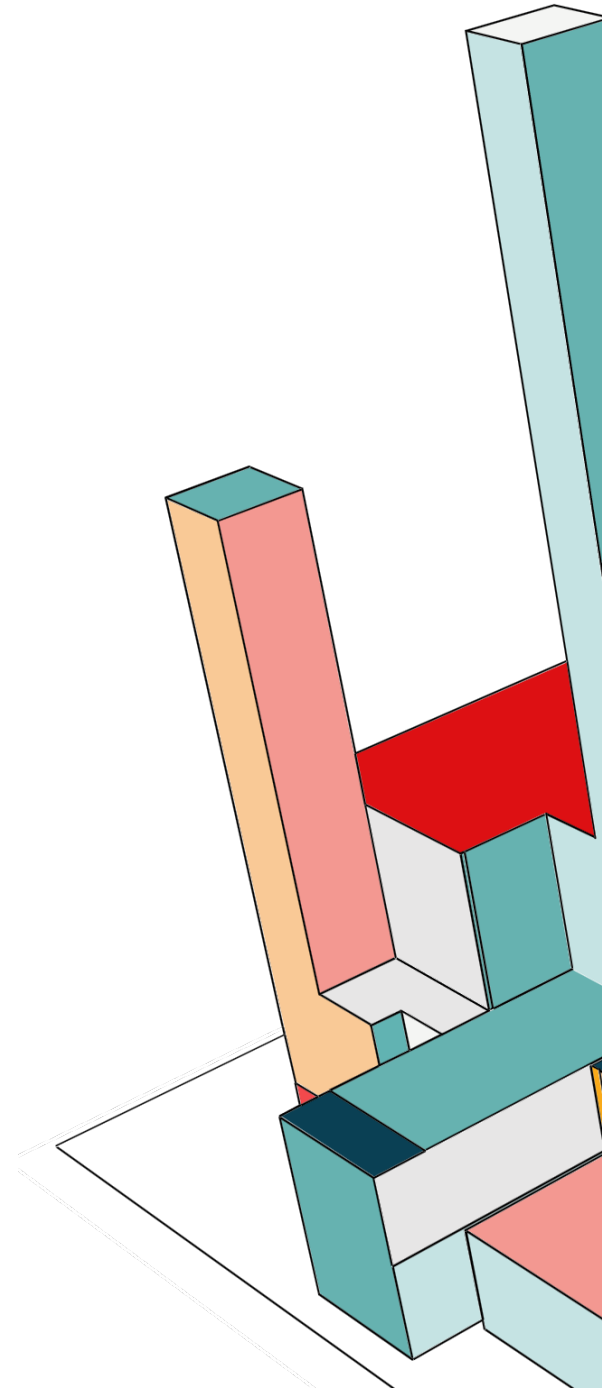

# FROM INSIGHTS TO IMPACT

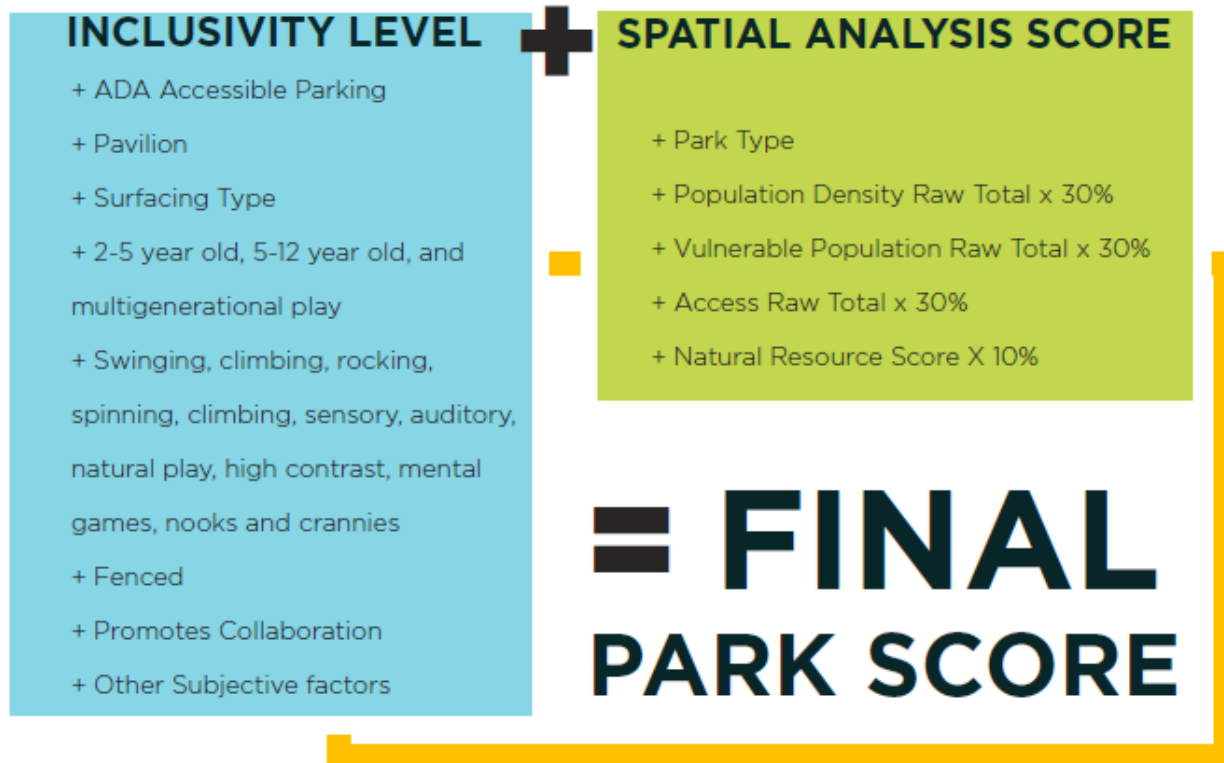

Figure 4.1 Cumulative of Inclusivity Level and the Spatial Analysis Score.

A final park score was formulated to rank parks in need of improvements.

The score included a Spatial Analysis Score (site context) and an Inclusivity Level (site specific).



# STATE OF PLAY - 2018

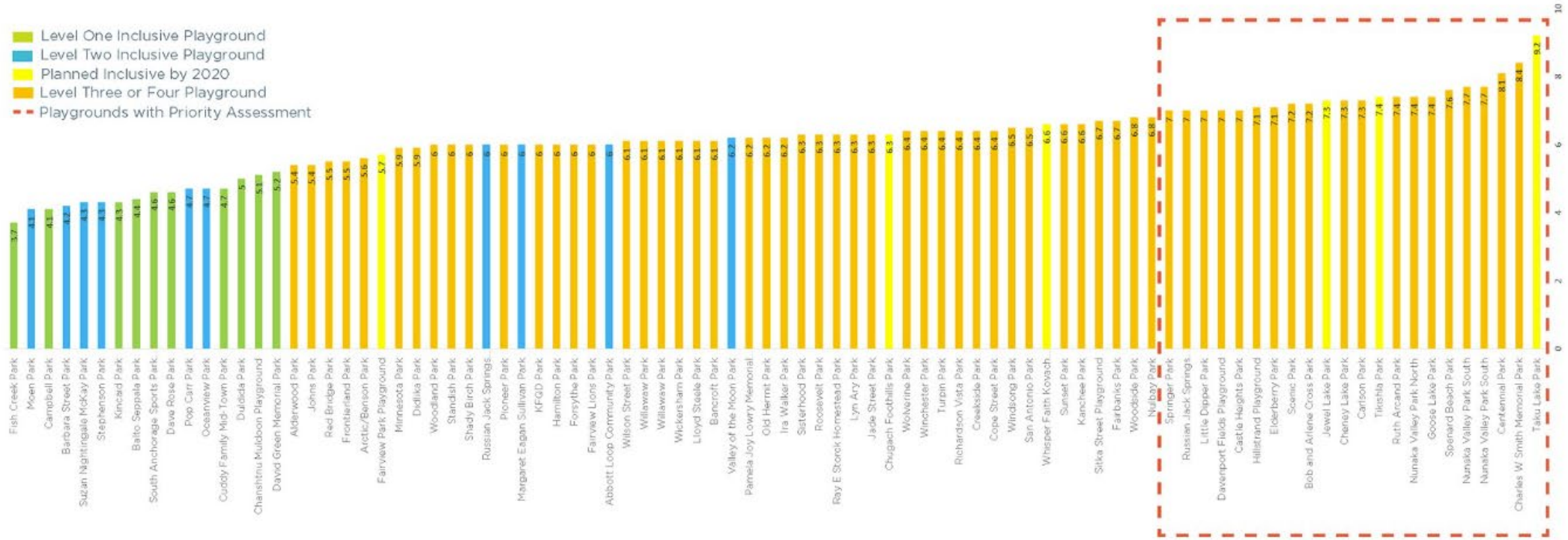
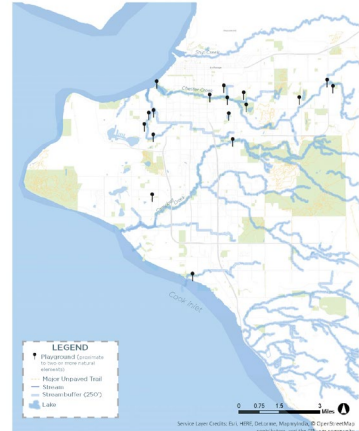
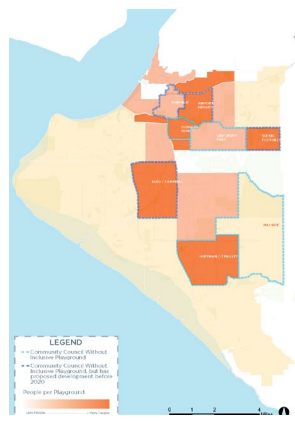
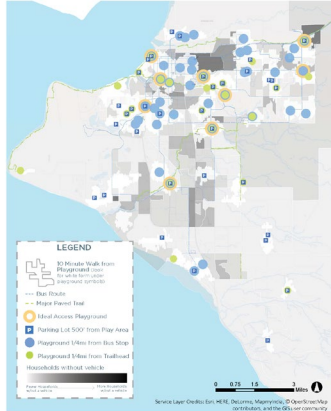

Figure 4.2 Final Playground Score (Anchorage Bowl Only)

# SPATIAL SCORE

ACCESS ANALYSIS: PLAYGROUNDS IN ANCHORAGE BOWL



## POPULATIONS LIVING WITH A DISABILITY

DOT DENSITY: INDIVIDUALS WITH A DISABILITY BY AGE GROUP



DOT DENSITY: INDIVIDUALS UNDER 18 or OVER 65 YEARS OF AGE WITH A DISABILITY

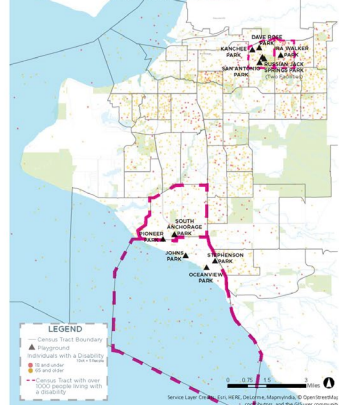

VULNERABLE POPULATIONS: TRACTS IN ANCHORAGE

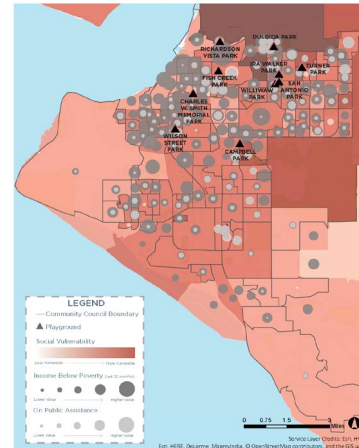

In addition to understanding overall vulnerable populations, Anchorage Parks and Recreation wanted to have a better idea of the parts of our community that have high numbers of individuals who experience disabilities.

## PEOPLE PER PLAYGROUND

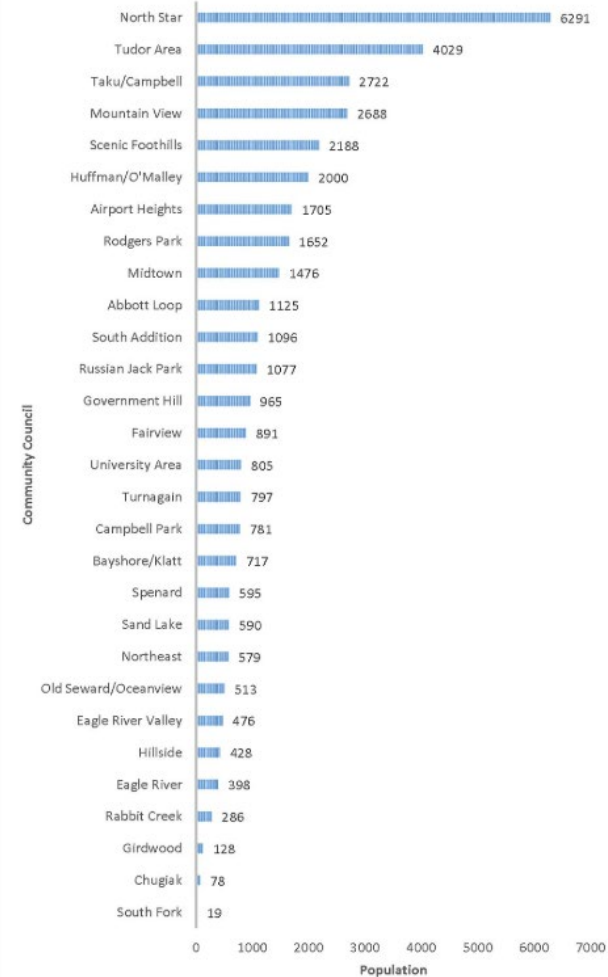



# INCLUSIVITY LEVEL



At Chanshtnu at Muldoon Playground in East Anchorage, 2017.



Kiwanis Fish Creek Park, 2016



South Anchorage Sports Park, 2017

## INCLUSIVE PLAY SCORECARD

**PARK NAME:** \_\_\_\_\_

Equipment for 2-5yr  Equipment for 5-12yr

Parking Lot?  On Street Parking?

# of Parking Spots  # Accessible Spots

**SQUARE FOOT TOTAL SURFACING:**

Sq ft Pn  Sq ft Wood Chips  Sq ft Sand

Sq ft Turf  Sq ft Concrete  Sq ft Pea Gravel

**NOTES:**

**SITE ACCESS:**

Distance to closest bus stop: \_\_\_\_\_

Distance to closest trailhead: \_\_\_\_\_

Distance from parking to playground: \_\_\_\_\_

Number and type of obstacles present from parking lot to playground: \_\_\_\_\_

Water feature ADA accessible?

**BASELINE INVENTORY**

# Swings  # Pavilions

# Benches

# Picnic Tables

OVERVIEW

## PLAY OPPORTUNITIES

	POOR	FAIR	GOOD	GREAT
<b>ACCESS</b>				
ADA Parking:				
Accessible surfaces and surfacing:				
Play with a variety of levels that is inclusive for those:				
<b>SENSORY OPPS</b>				
Visual Elements including dynamic signage, high contrast or site context:				
Auditory Elements including musical activities, water features:				
Opportunities for smell including vegetation or interesting surfacing:				
Tactile opportunities including interesting surfacing, natural elements:				
Taste includes edible vegetation or nearby community gardens:				
Nooks and Crannies for quieter environments and play:				
<b>PHYSICAL OPPS</b>				
Opportunities for strength building?				
Spinning?				
Climbing?				
Swinging?				
Development of fine motor skills and Motor Planning?				
Are there activities with gravity and momentum?				
Transfer points and rest nodes?				
<b>SOCIAL OPPS</b>				
Is the playground near the community?				
Can the playground be easily seen from inside and outside of the park?				
Are the quiet zones, or places for individual play?				
Are the zones for small group play and intimate (closer) interactions?				
Are there areas for large group play?				
<b>MENTAL OPPS</b>				
Wayfinding through dynamic and interesting signage:				
Element that promotes drama/creativity through programming:				
Element that provides exploration:				
Cause and effect games and element:				

OBSERVER \_\_\_\_\_ DATE \_\_\_\_\_



# GETTING AT OR BELOW “7”

Park Name	Park Score	In Design or on CIP
<b>Taku Lake Park</b>	<b>9.2</b>	<b>Yes</b>
Charles W Smith Memorial Park* (!)	8.4	No
<b>Goose Lake Park (!!)</b>	<b>8.4</b>	<b>Yes</b>
<b>Cheney Lake Park (!)</b>	<b>8.3</b>	<b>Yes</b>
<b>Centennial Park* (!)</b>	<b>8.1</b>	<b>Yes</b>
Davenport Fields Park*	8.0	No
<b>Woodside Park (Eastchester)</b>	<b>7.8</b>	<b>Yes</b>
<b>Nunaka Valley Park South</b>	<b>7.7</b>	<b>Yes</b>
<b>Spenard Beach Park*</b>	<b>7.6</b>	<b>Yes</b>
<b>Nunaka Valley Park North</b>	<b>7.4</b>	<b>Yes</b>
Ruth Arcand Park*	7.4	No
Carlson Park	7.3	No
Scenic Park	7.2	No
<b>Bob and Arlene Cross Park</b>	<b>7.2</b>	<b>Yes</b>

Many of these projects are in design or are on the Capital Improvement Plan for funding and development in the next five years.

Note: Throughout the presentation (!) indicates a CC CIP Survey Request and \* indicates additional information is needed to consider development of this asset.



# COMMUNITY-USE AS PRIORITY

Park Name	Park Score	Inclusivity Score	In Design or on CIP
Abbott Loop Community Park	6	2	-
Balto Seppala Park	4	1	-
Chanshtnu Muldoon Park	5	1	-
Cuddy Family Mid-Town Park	5	1	-
Dave Rose Park	5	1	-
<b>Goose Lake Park</b>	<b>8</b>	<b>4</b>	<b>Yes</b>
Jade Street Park	6	3	-
<b>Jewel Lake Park</b>	<b>4</b>	<b>1</b>	<b>Yes</b>
<b>Lyn Ary Park</b>	<b>6</b>	<b>3</b>	<b>Yes</b>
Margaret Eagan Sullivan Park	6	2	-
Ray E Storck Homestead Park	6	3	-
<b>Spenard Beach Park</b>	<b>8</b>	<b>4</b>	<b>Yes</b>
<b>Taku Lake Park</b>	<b>9</b>	<b>4</b>	<b>Yes</b>
Valley of the Moon Park	6	2	-
William B Lyons Park	5	1	-

Ensure Community-use assets are inclusive is important for our community, as these parks have the assets to accommodate a larger number of users and are ultimately intended to serve a larger portion of the population.

*Note: Spenard Beach and Taku are under design. Lyn Ary and Goose Lake are on deck. Ray E Storck and Jade Street should be added to the improvement list as other project gets completed.*



# EVERY COMMUNITY COUNCIL

Park Name	Inclusive Playgrounds	Total Playgrounds	Next Candidate Park Has Asset in Design or on CIP	
Abbott Loop	2	4	-	-
Airport Heights	1	3	-	-
Bayshore/Klatt	1	3	-	-
Campbell Park	1	3	-	-
Chugiak	2	5	-	-
Eagle River	4	6	-	-
Eagle River Valley	2	2	-	-
Girdwood	0	1	-	-
Government Hill	1	3	Richardson Vista	Yes
<b>Hillside</b>	<b>0</b>	<b>1</b>	<b>Forsythe Park</b>	<b>Yes</b>
<b>Huffman/O'Malley</b>	<b>0</b>	<b>1</b>	<b>Bob and Arlene Cross Park</b>	<b>Yes</b>
Midtown	1	3	-	-
Mountain View	2	2	-	-
<b>North Star</b>	<b>0</b>	<b>1</b>	<b>Charles E Smith Park</b>	-
Northeast	2	11	Nunaka Valley North	Yes
Old Seward/Oceanview	3	4	-	-
Rabbit Creek	1	2	-	-
<b>Rogers Park</b>	<b>0</b>	<b>2</b>	<b>Carlson Park</b>	-
Russian Jack	2	7	-	-
Sand Lake	2	5	-	-
<b>Taku/Campbell</b>	<b>0</b>	<b>1</b>	<b>Taku Lake Park</b>	<b>Yes</b>
Tudor Area	1	1	-	-
Turnagain	2	6	Lyn Ary Park	Yes
University Area	1	3	Goose Lake Park	Yes

Completing the following would qualify every community council having an inclusive playground: Taku Lake, Carlson Park, Charles E Smith, Forsythe Park, Bob and Arlene Cross Park.

Note: Eastchester Playground is in design and on the boundary of Rogers Park CC. Charles E Smith Playground is adjacent to a CIHA Playground in Northstar CC.

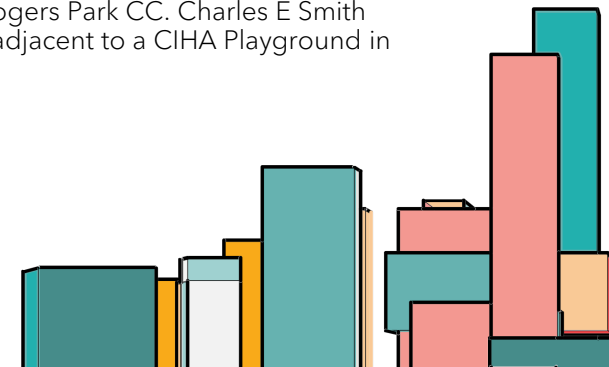

# COMPLETED PROJECTS (35)

2012 Project Valley of the Moon Park  
2013 Project Cuddy Family Mid-Town Park  
2013 Project Fairbanks Park  
2013 Project Fairview Lions Park  
2013 Project Margaret Eagan Sullivan Park  
2013 Project Russian Jack Springs (Polar Bear) Park  
2014 Project Abbott Loop Community Park  
2014 Project Balto Seppala Park  
2014 Project Campbell Park  
2014 Project Oceanview Park  
2014 Project Stephenson Park  
2014 Project Pioneer Park  
2014 Project Pop Carr Park  
2015 Project Moen Park  
2015 Project Suzan Nightingale McKay Park  
2016 Project Duldida Park  
2016 Project David Green Memorial Park  
2016 Project Barbara Street Park  
2016 Project Dave Rose Park  
2016 Project Duldida Park  
2016 Project Kiwanis Fish Creek Park  
2017 Project Kincaid Park  
2017 Project South Anchorage Sports Park Playground  
2018 Project Whisper Faith Kovach Memorial Park  
2018 Project Chugach Foothills Park  
2019 Project Chanshtnu Muldoon Park  
2019 Project Fairview Delgga Park  
2019 Project Folker Park  
2020 Project Fairview Recreation Center Indoor Playground  
2020 Project Hamilton Park  
2021 Project Tikishla Park  
2021 Project Frontierland Park  
2022 Project Jewel Lake Park  
2022 Project William B Lyons Park  
2024 Project Elderberry Park

## ON DECK (22)

### ACTIVE PROJECTS

2023 Bond Taku Lake Park  
2023 Bond KFQD Park  
2023 Bond Spenard Beach Park  
2024 Bond Richardson Vista Park  
2024 Leg. Creekside Park  
2024 Leg. Turpin Park  
2025 Bond Goose Lake Park  
2025 Bond Nunaka Valley Park North  
2025 Bond Woodside Park (Eastchester)

### UP NEXT

2026 Bond Cope Street Park  
2026 Bond Ira Walker Park  
2026 Bond Lyn Ary Park  
2027 Bond Castle Heights Park  
2027 Bond Centennial Park  
2028 Bond Cheney Lake Park  
2028 Bond Johns Park  
2028 Bond Nunaka Valley Park South  
2029 Bond Forsythe Park  
2029 Bond Winchester Park  
2029 Bond Sitka Street Playground  
2030 Bond Didlika Park  
2030 Bond Wilson Street Park

## 2030+ (16)

Springer Park  
Woodland Park  
Charles W Smith Memorial Park  
Red Bridge Park  
Carlson Park  
Little Dipper Park  
Nulbay Park  
Bob and Arlene Cross Park  
Kanchee Park  
Scenic Park  
San Antonio Park  
Roosevelt Park  
Ray E Storck Homestead Park  
Windsong Park  
Arctic/Benson Park  
Sunset Park

*Note:* Priorities can change and shift based on a number of factors. The schedule above is reflective of the 2024 CIP priorities and CC Survey Rankings.



# INCLUSIVE PLAY INTO TOMORROW

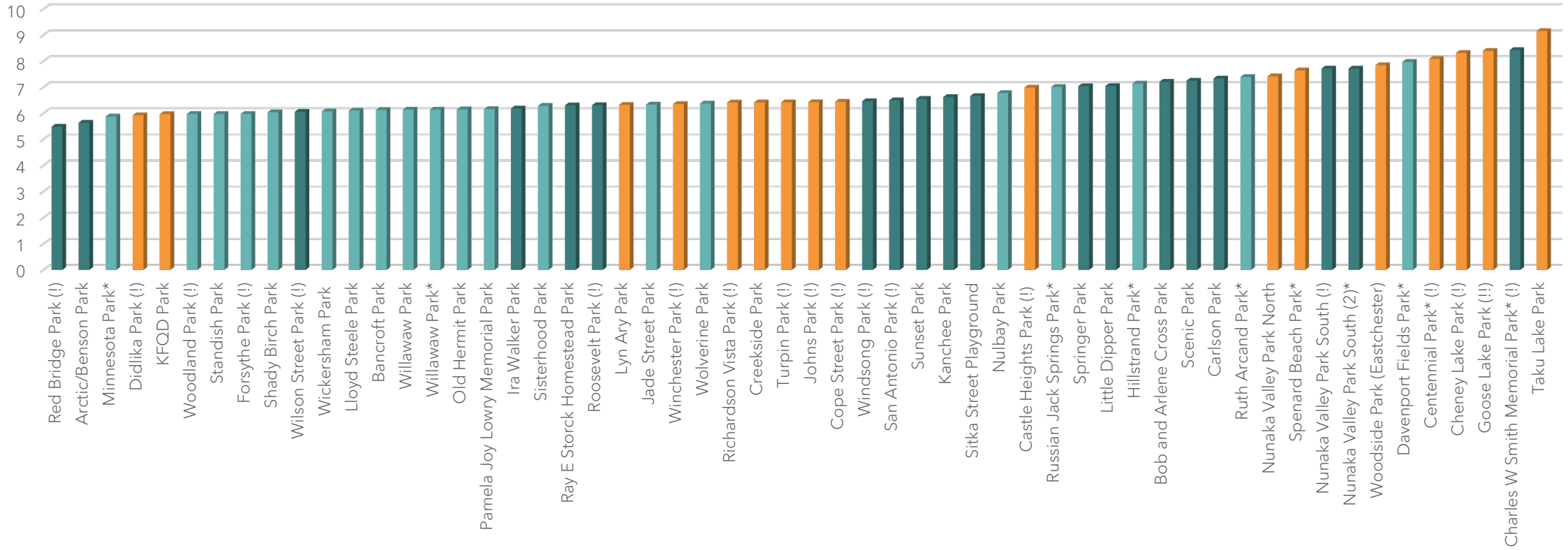



# SUMMARY

- Parks is working to improve our CIP process and selection to be more transparent, data driven, and accessible.
- Parks has mechanisms outside of the CIP that help support our department's decision making on capital improvement development, such as the State of Play.
- These documents are not static; **they grow and improve through iteration and insight.**
- *We welcome questions and feedback to make this process better.*

# THANK YOU!

Taylor Keegan, Superintendent  
Anchorage Parks and Recreation  
[taylor.keegan@anchorageak.gov](mailto:taylor.keegan@anchorageak.gov)

