



# Municipality of Anchorage

Development Services Department  
On-Site Water and Wastewater Section  
4700 Elmore Street  
P.O. Box 196650  
Anchorage, AK 99519-6650  
www.muni.org/onsite  
(907) 343-7904



## PERMIT REQUIREMENTS FOR A PRIVATE WATER WELL

**Permit.** An application to drill a new or replacement well shall be submitted to this department by the property owner or their agent prior to commencement of drilling operations for a single family or duplex water well. A permit for a private water well shall not be issued if there is no existing or permitted on-site wastewater disposal system or connection to public sewer service for the property available, scheduled and approved. The permit for a private water well shall be valid for one year from the date of issue.

**Application.** The application shall be on a form provided by the department. The applicant shall submit an accurate site plan signed by the property owner or property owner's agent drawn on an 8-1/2 by 11-inch sheet (or larger if necessary) to a scale not smaller than 1 inch to 50 feet. The site plan shall include a statement signed by the property owner or authorized agent attesting that the well will be sited, drilled and completed in accordance with standards and provisions in AMC Chapters 15.55 and 15.65. The site plan shall show:

1. Legal description of the lot or parcel;
2. Location of the proposed well;
3. Lot lines, roads, rights-of-way and easements on or adjacent to the lot;
4. Location of all proposed or existing structures on the lot;
5. Location of all wells within 100 feet of the proposed well on the subject and adjacent properties;
6. All applicable protective well radii; and
7. The location or proposed location of all components listed below and areas containing hazardous waste or other potential pollutants within 150 feet of the proposed well.

The minimum separation requirements between a private water supply well and specified facilities or areas shall be:

<u>SEPARATION OF WELL FROM:</u>	<u>MIN. SEPARATION DISTANCE IN FEET</u>
Subsurface drain	25
Petroleum hydrocarbon storage tank	25
Private sewer line/sewer service line (including stormwater service line)	25
Animal containment areas	50
Advanced wastewater treatment system with remove monitoring	50
Sewer line/sewer main (including stormwater)	100
Sewage holding tank/ Septic tank	100
Manure/animal excreta storage areas	100
Septic absorption field	100
Sewer manhole or clean-out	100
Any other source of potential contamination	100

**Attention:** To close out the well permit the following are to be submitted to the Department:

- Well Log
- Pump Log
- Water sample results from a SOA certified lab for total coliform bacteria, nitrate and arsenic
- Well Decommissioning Log (if applicable)

# Well Permit Site Plan Requirements

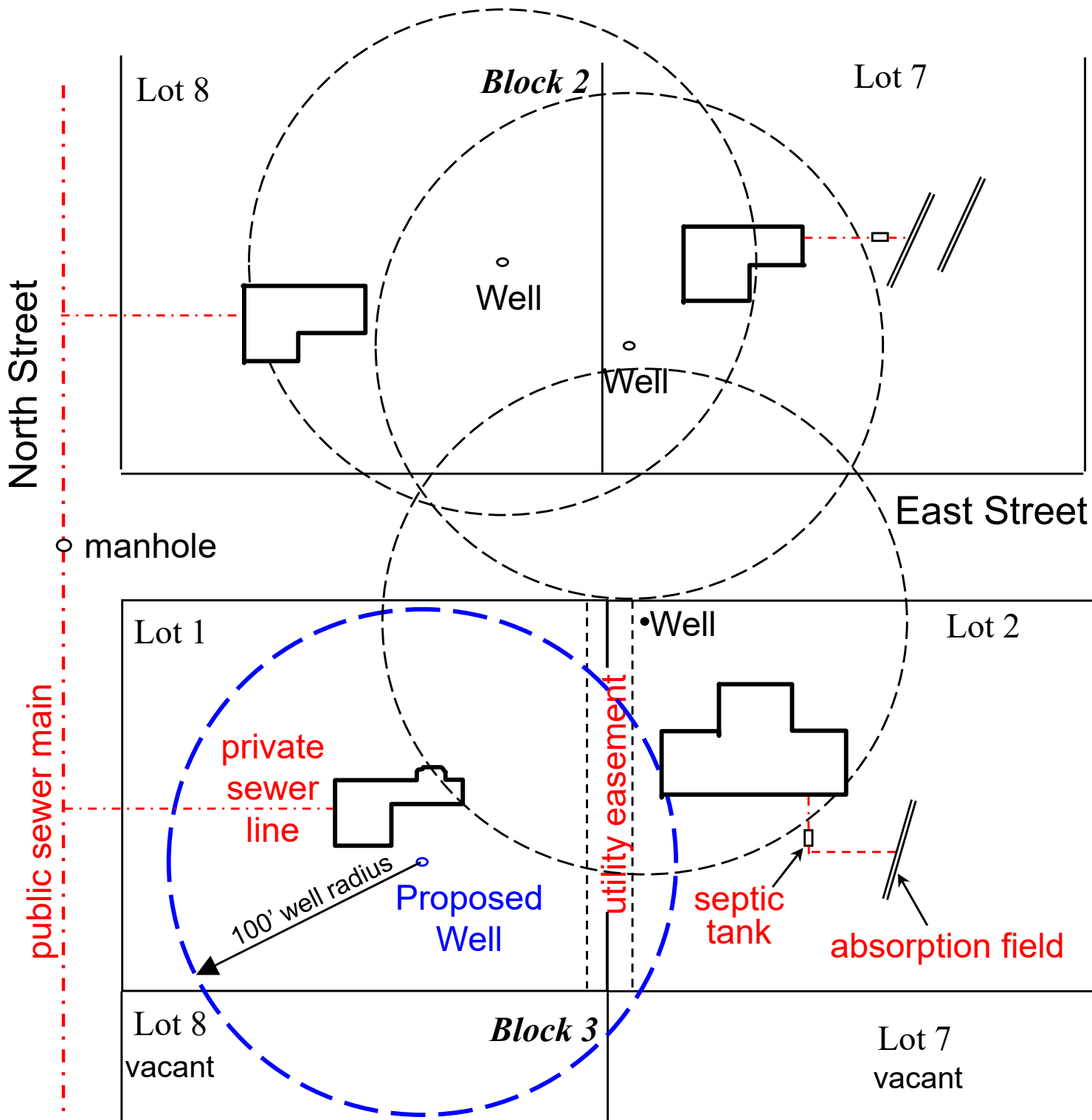

Owner's  
Statement and  
Signature